

ITEM NO.	PART NUMBER	DESCRIPTION	QTY.
1	100501	BUCKET WELDMENT	1
2	100515	PIVOT WELDMENT, LEFT	1
3	100518	PIVOT WELDMENT, RIGHT	1
4	100521	SMALL TUBE	2
5	100522	FRONT HOLDER WELDMENT	1
6	100527	PLATE, MOTOR MOUNT	1
7	100528	SHAFT	1
8	100529	TINE WELDMENT	12
9	100532	ARM REST WELDMENT	2
10	100543	COUPLER, WELDMENT	1
11	100538	ROD, HINGE	1
12	100539	ROD, PIN	2
13	100540	HINGE PIPE	8
14	100541	TOP PLATE	1
15	Motor	7.63 CU IN PTO DRIVE MOTOR	1
16	Bearing, FS210	BEARING, FS210	2
17	Shaft Collar	DOUBLE SPLIT SHAFT COLLAR- 1-7/8"	1
18	CP-125X2500	COTTER PIN, 1/8 X 2 1/2	6
19	SAE 10M to 0.5NPTF	FITTING, SAE 10M TO 1/2"NPTF SWIVEL	2
20	SAE 4M to 0.25NPTF Swivel	FITTING, SAE 4M TO 1/4"NPTF SWIVEL	1
21	HBOLT 0.3750-16x3x3-C	HBOLT 0.3750-16x3x3	1
22	HBOLT 0.5000-13x2.5x2.5	HBOLT 0.5000-13x2.5x2.5	2
23	HBOLT 0.6250-11x1.75x1.75-C	HBOLT 0.6250-11x2x2	8
24	HBOLT 0.7500-10x1.25x1.25	HBOLT 0.7500-10x1.25x1.25	14
25	HBOLT 0.7500-10x1.5x1.5-N	Bolt, HHCS, 0.75"-10x1.5"x1.5"	4
26	HBOLT 0.7500-10x2x2-C	Bolt, HHCS, 0.75"-10x2"x2"	2
27	HBOLT 0.7500-10x5.5x1.75-C	Bolt, HHCS, 0.75"-10x5.5"x1.75"	2
28	HBOLT 1.0000-8x3x2.25-C	Bolt, HHCS, 1.0"-8x3"x2.25"	2
29	Preferred Wide FW 0.5	Washer, Wide, 0.5"	2
30	Preferred Wide FW 0.625	Washer, 0.625" Wide	8
31	WASHER 0.7500-WIDE	Washer, Wide, 0.75"	6
32	WASHER 1.000-WIDE	Washer, Wide, 1.0"	4
33	HNUT 0.3750-16-D-C	Nut, Hex, 0.375"-16	1
34	HNUT 0.5000-13-D-C	Nut, Hex, 0.5"-13	2
35	HNUT 0.6250-11-D	HNUT 0.6250-11-D	8
36	HNUT 0.7500-10-D	Nut, Hex, 0.75"-10	4
37	HNUT 1.0000-8-D-C	Nut, Hex, 1"-8	2

NOTES:

- IN ONLY ONE PART IS VIEWABLE, BUT THERE IS A MULTIPLIER BESIDES THE FIND NUMBER (FN) THEN IT IS IMPLIED THAT THE PART ARE SYMETRIC ON THE OTHER SIDE.
- TO ATTACH THE TOP PLATE (FN 26) TO THE BUCKET WELDMENT (FN 1) FIRST PLACE ALL 8X HINGE PIPES (FN 25) ON HINGE ROD (FN 14). LAY THE TOP PLATE ON THE FLOOR AND POSITION ROD WITH HINGE PIPES ON IT NEXT TO IT AND WELD FOUR OF THE HINGE PIPES TO THE COVER PLATE APPROXIMATELY POSITIONED AS SHOWN ON SHEET 3.
- POSITION TOP PLATE (FN 26) WITH WELDED ON HINGE PIPE AND ROD AND POSITION ON BUCKET WELDMENT. WELD REMAINIG 4 HINGE PIPES (FN 25) TO BUCKET WELDMENT.
- HYDRAULIC HOSES AND QUICK CONNECT HYDRAULIC COUPLINGS ARE NOT SHOWN IN IN THIS DRAWING OR BOM.
- THREAD LOCKER SUCH AS LOCTITE IS RECOMMENDED FOR ALL BOLTED CONNECTIONS
- NYLON NUT SHOULD BE USED FOR FN 37 SO THAT JOINT CAN BE LEFT SLIGHTLY LOOSE.

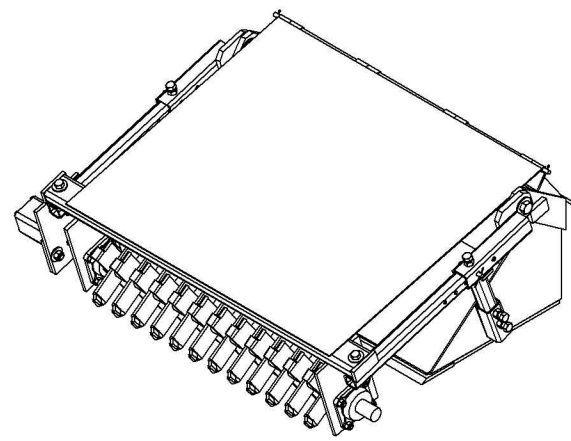

	NAME	DATE	PROJECT:
	DRAWN MA	2011-12-22	PULVERIZER
	CHECKED	YYYY/MM/DD	DESCRIPTION:
	APPR.	YYYY/MM/DD	SOIL PULVERIZER ASSEMBLY
UNLESS OTHERWISE SPECIFIED DIMENSIONS ARE IN INCHES			
ANGLES	.X	.XX	.XXX
	±.5	±.1	±.03
		SIZE DWG. NO.	REV
THIRD ANGLE PROJECTION		B 100500	A
		SCALE: NONE	WEIGHT: XX.XLBS
		SHEET 1 OF 3	

D

C

B

A

D

C

B

A

8 7 6 5 4 3 2 1

D

D

C

C

B

B

A

A

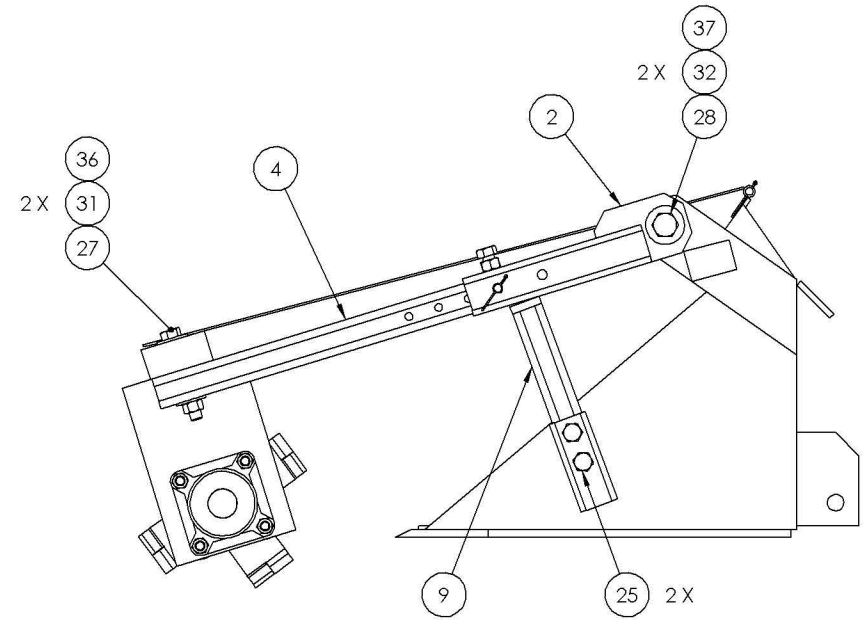
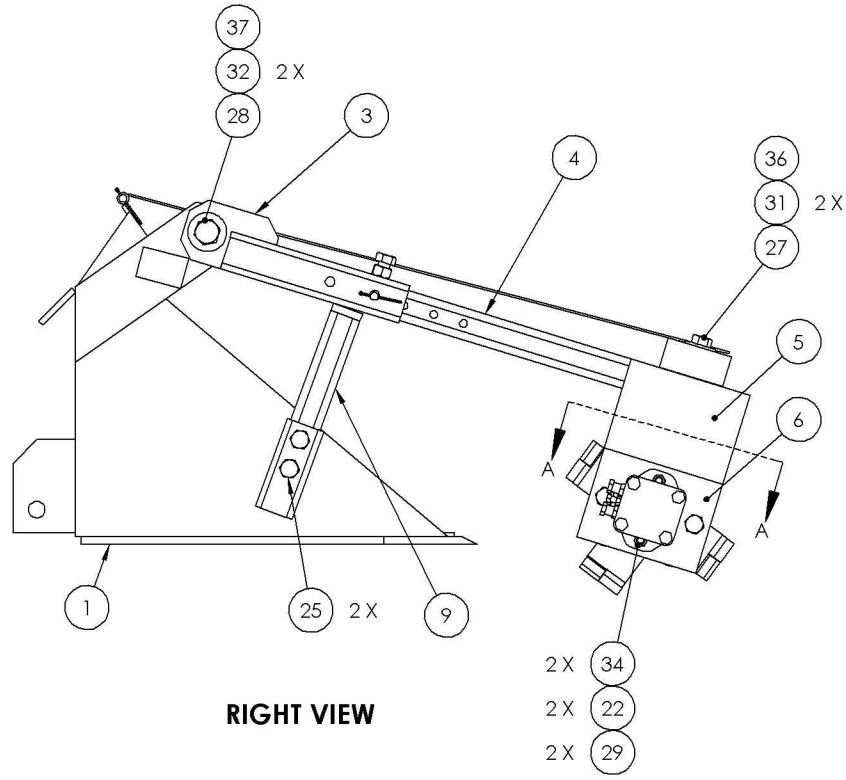

SIZE	DWG. NO.	REV
B	100500	A
PULVERIZER		SCALE: NONE SHEET 2 OF 3

8 7 6 5 4 3 2 1

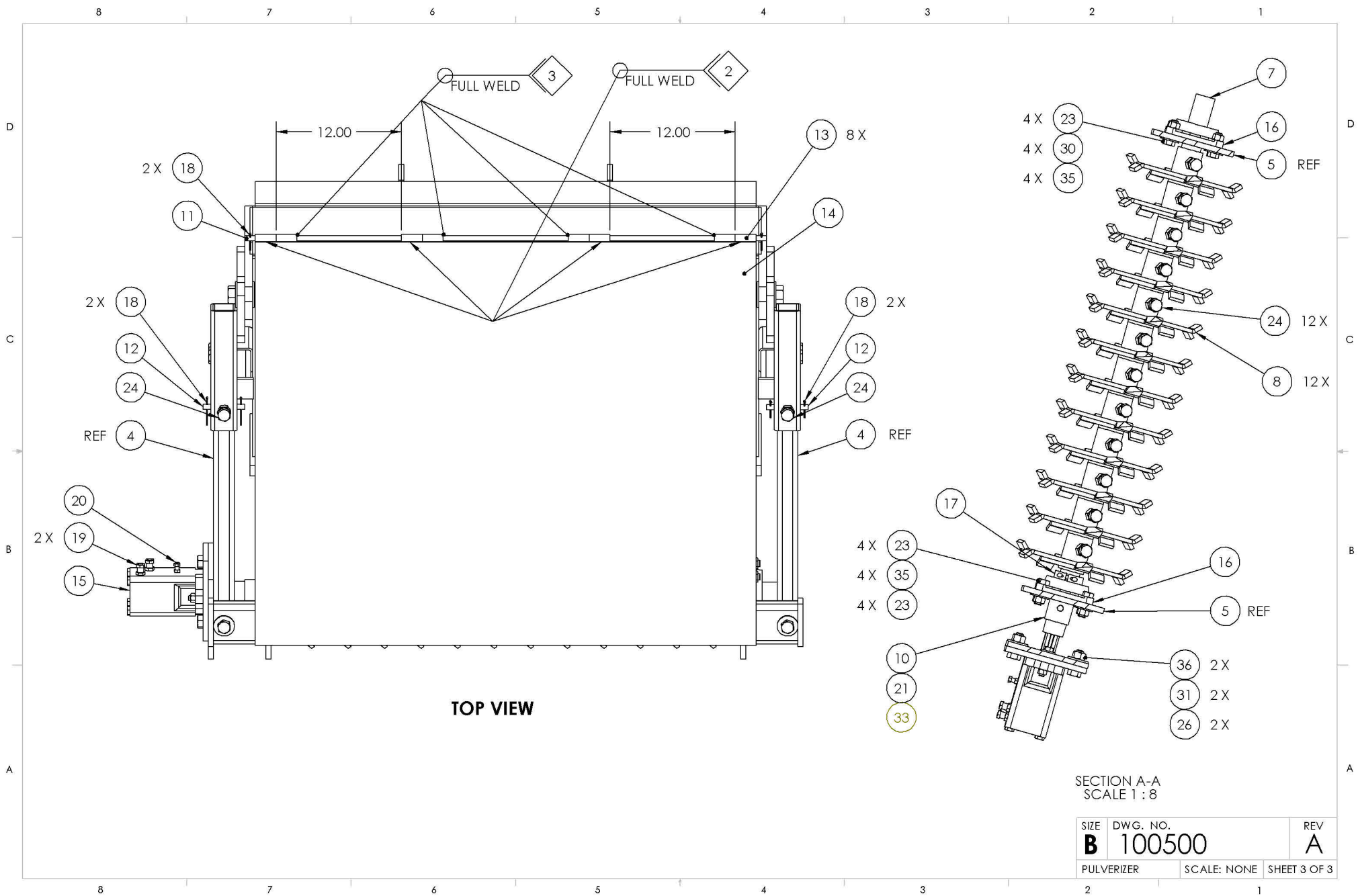

NOTES:

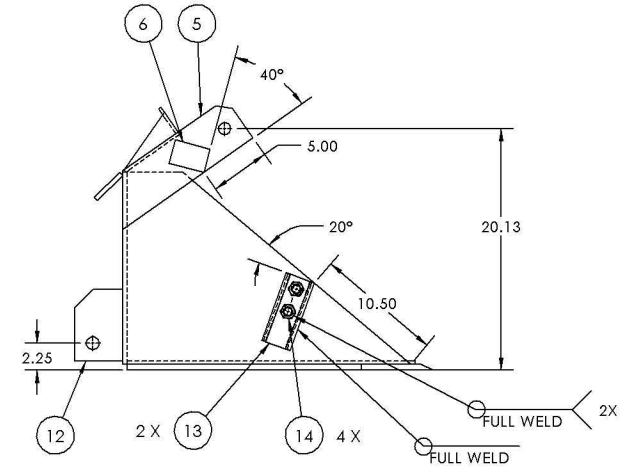
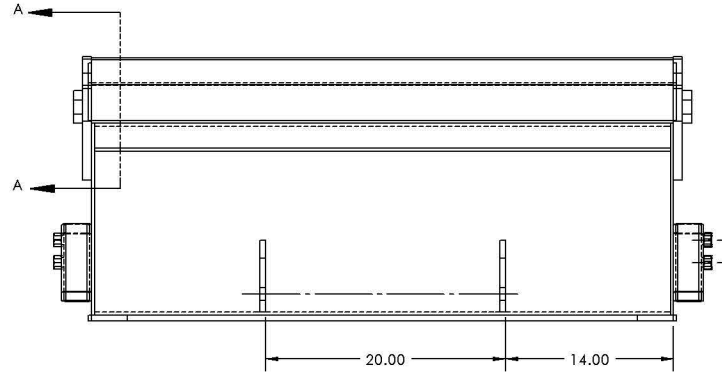

REPEAT LOCATION AND WELD OF ITEM NO. 5, 6, 13, 14 ON OPPOSITE SIDE

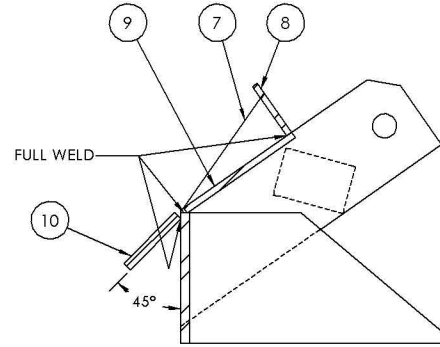

SECTION A-A
SCALE 1 : 4

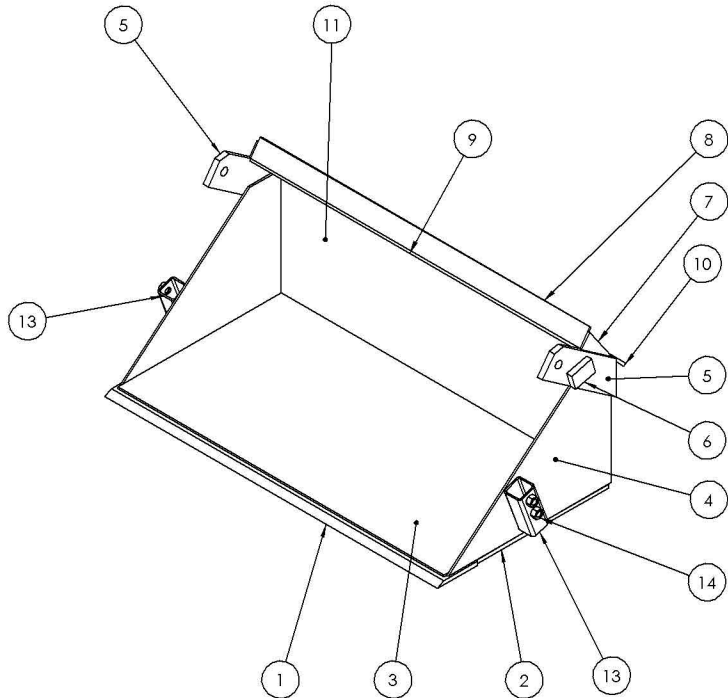

ITEM NO.	PART NUMBER	DESCRIPTION	QTY.
1	100502	BLADE	1
2	100503	SKID PLATE	2
3	100504	BOTTOM PLATE	1
4	100505	SIDE PLATES	2
5	100506	SIDE BRACE PLATE	2
6	100507	HARD STOP PLATE	2
7	100508	TRIANGLE PLATE	2
8	100509	CROSS SUPPORT PLATE	1
9	100510	CROSS SUPPORT PLATE LOWER	1
10	100511	REAR MOUNTING PLATE	1
11	100512	BACK PLATE	1
12	100513	BOTTOM MOUNTING PLATES	2
13	100514	LARGE TUBE, ANGLED	2
14	HNUT 0.7500-10-D-Steel	Nut, Hex, Steel, 0.75"x10	4

open source ecology

LICENSE INFORMATION
ALL INFORMATION IS RELEASED UNDER THE GSE
LICENSE FOR DISTRIBUTIVE ECONOMICS. FOR
FURTHER INFORMATION GO TO:
OPENSOURCEECOLOGY.ORG/AVLIC/USE

NAME	DATE	PROJECT:
DRAWN	YYYY/MM/DD	Pulverizer
CHECKED	YYYY/MM/DD	DESCRIPTION:
APPR.	YYYY/MM/DD	BUCKET WELDMENT
<small>UNLESS OTHERWISE SPECIFIED DIMENSIONS ARE IN INCHES</small>		
ANGLES	X .XX .XXX ± .5 ± .1 ± .03 ± .005	SIZE DWG. NO. C 100501
THIRD ANGLE PROJECTION	SCALE: NONE	WEIGHT: XX.XLBS
		SHEET 1 OF 2

REV
A

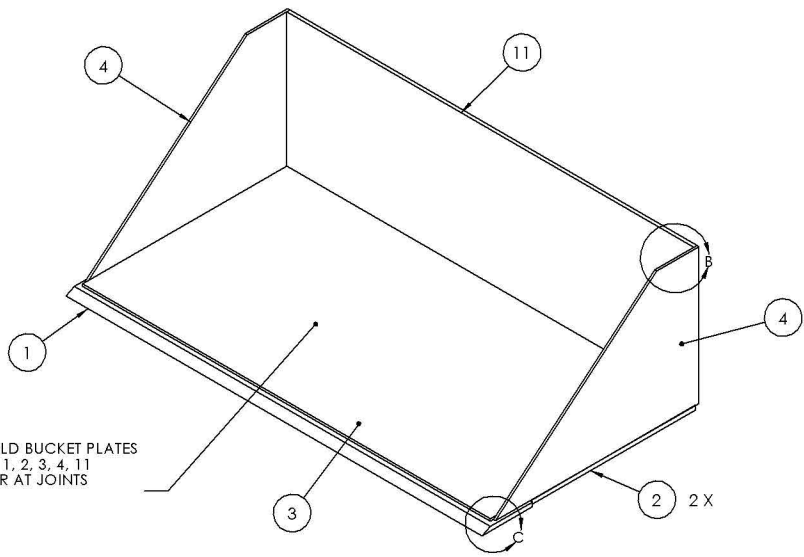

FULLY WELD BUCKET PLATES
ITEM NO. 1, 2, 3, 4, 11
TOGETHER AT JOINTS

ISO VIEW
(ITEMS REMOVED FOR CLARITY)

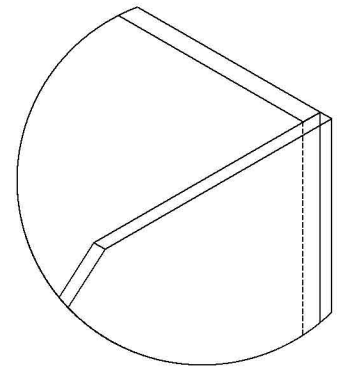

DETAIL B
SCALE 1 : 1.5

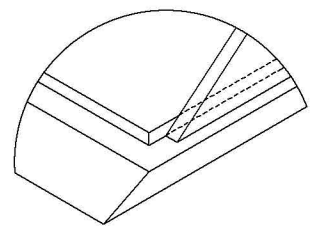

DETAIL C
SCALE 1 : 1.5

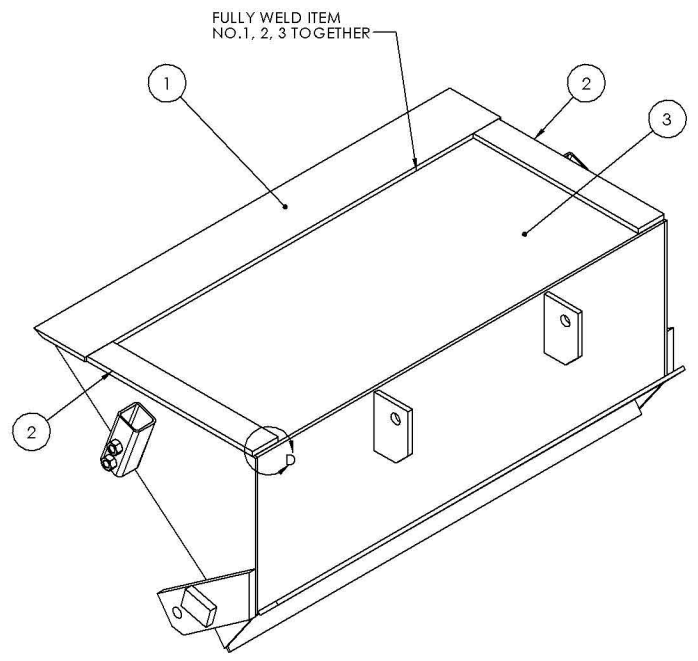

ISO VIEW - BOTTOM

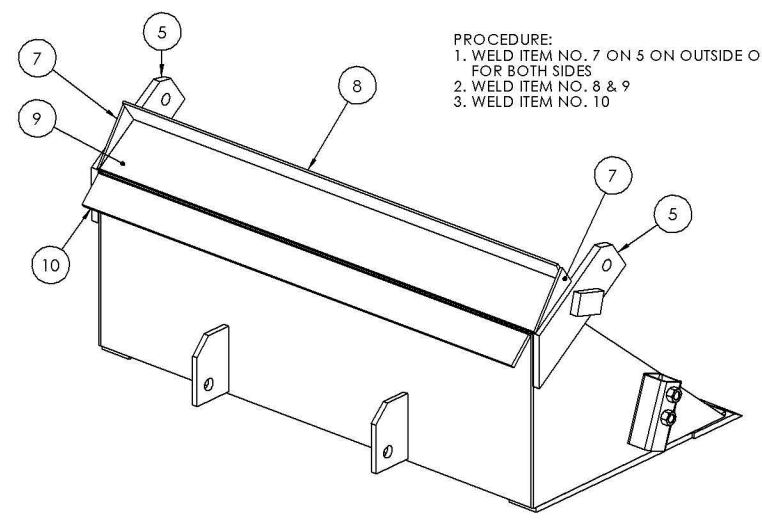

PROCEDURE:
1. WELD ITEM NO. 7 ON 5 ON OUTSIDE ONLY
FOR BOTH SIDES
2. WELD ITEM NO. 8 & 9
3. WELD ITEM NO. 10

ISO VIEW - REAR

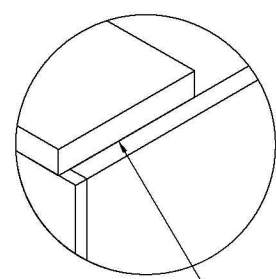

DETAIL D
SCALE 1 : 1.5

SIZE	DWG. NO.	REV
C	100501	A
PULVERIZER	SCALE: NONE	SHEET 2 OF 2

NOTES:

- MATERIAL:
ASTM A36 STEEL

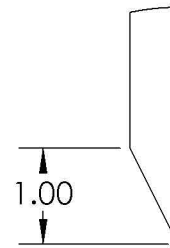
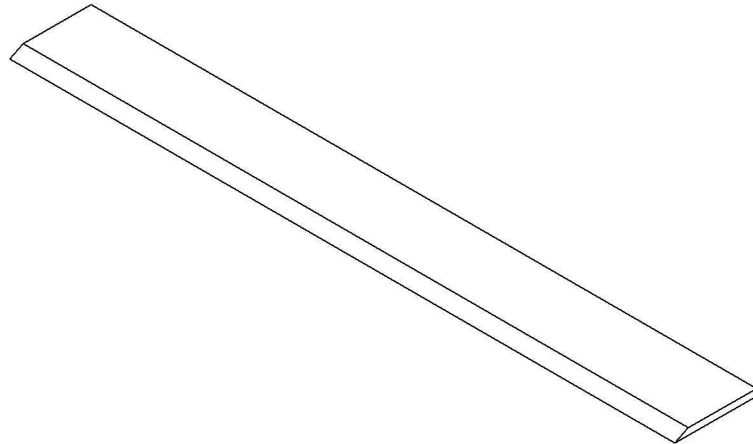
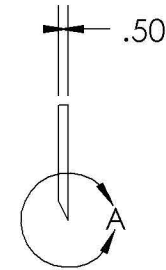
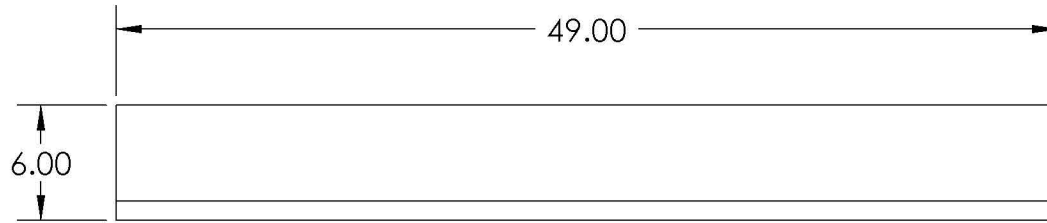

DETAIL A
SCALE 1 : 2



LICENSE INFORMATION
ALL INFORMATION IS RELEASED UNDER THE OSE
LICENSE FOR DISTRIBUTIVE ECONOMICS. FOR
FURTHER INFORMATION GO TO:
OPENSOURCEECOLOGY.ORG/WIKI/LICENSE

	NAME	DATE
DRAWN	MA	2011-12-22
CHECKED		YYYY/MM/DD
APPR.		YYYY/MM/DD
UNLESS OTHERWISE SPECIFIED DIMENSIONS ARE IN INCHES		
ANGLES	.X	.XX
	±.5	±.1
		±.03
		±.005

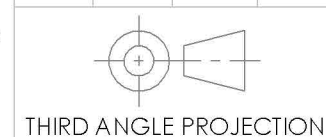

PROJECT:
PULVERIZER

DESCRIPTION:
BLADE

SIZE A	DWG. NO. 100502	REV A
------------------	---------------------------	-----------------

SCALE: 1:10	WEIGHT: 38.2LBS	SHEET 1 OF 1
-------------	-----------------	--------------

NOTES:

- MATERIAL:
ASTM A36 STEEL

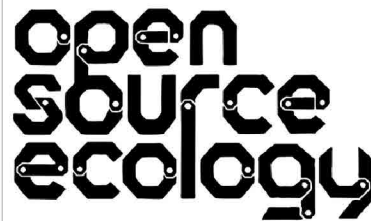
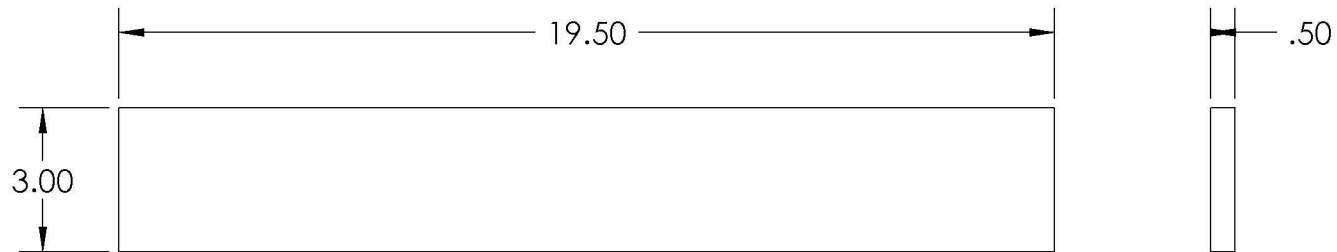

LICENSE INFORMATION
 ALL INFORMATION IS RELEASED UNDER THE OSE
 LICENSE FOR DISTRIBUTIVE ECONOMICS. FOR
 FURTHER INFORMATION GO TO:
OPENSOURCEECOLOGY.ORG/WIKI/LICENSE

	NAME	DATE
DRAWN	MA	2011-12-22
CHECKED		YYYY/MM/DD
APPR.		YYYY/MM/DD
UNLESS OTHERWISE SPECIFIED DIMENSIONS ARE IN INCHES		
ANGLES	.X	.XX
	± .5	± .1
		± .03
		± .005

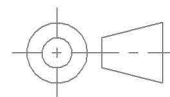

THIRD ANGLE PROJECTION

PROJECT:
PULVERIZER

DESCRIPTION:
SKID PLATE

SIZE	DWG. NO.	REV
A	100503	A

SCALE: 1:4	WEIGHT: 8.4LBS	SHEET 1 OF 1
------------	----------------	--------------

NOTES:

- MATERIAL:
ASTM A36 STEEL

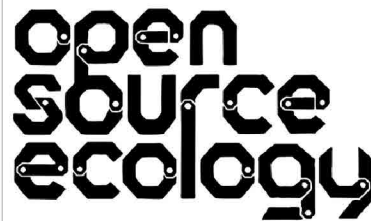
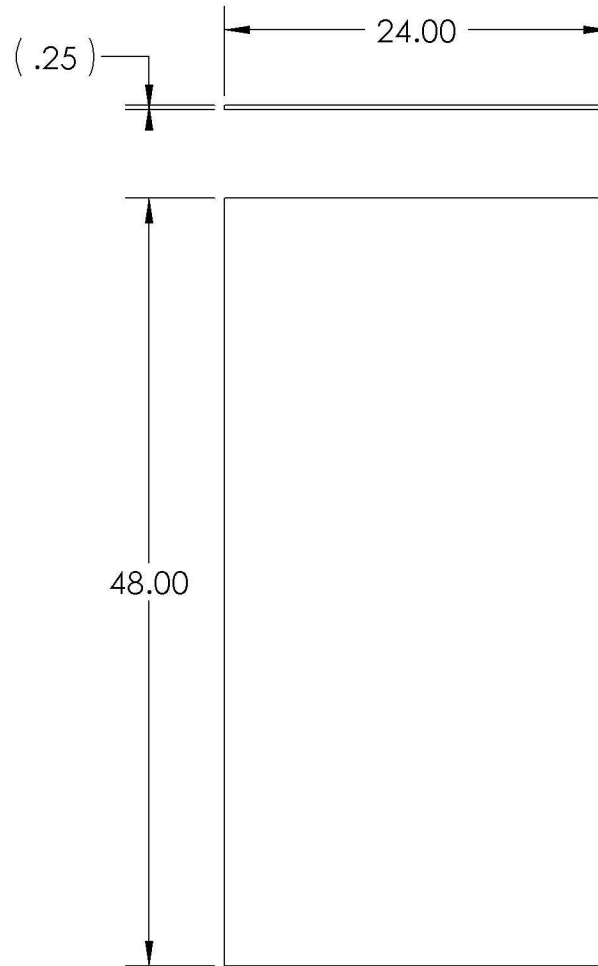

LICENSE INFORMATION
 ALL INFORMATION IS RELEASED UNDER THE OSE
 LICENSE FOR DISTRIBUTIVE ECONOMICS. FOR
 FURTHER INFORMATION GO TO:
OPENSOURCEECOLOGY.ORG/WIKI/LICENSE

	NAME	DATE		
DRAWN	MA	2011-12-22		
CHECKED		YYYY/MM/DD		
APPR.		YYYY/MM/DD		
UNLESS OTHERWISE SPECIFIED DIMENSIONS ARE IN INCHES				
ANGLES	.X	.XX	.XXX	
	± .5	± .1	± .03	± .005

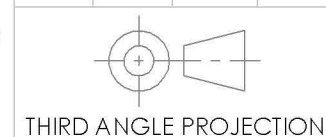

PROJECT:
PULVERIZER

DESCRIPTION:
BOTTOM PLATE

SIZE	DWG. NO.	REV
A	100504	A
SCALE: NONE	WEIGHT: 81.7LBS	SHEET 1 OF 1

NOTES:

- MATERIAL:
ASTM A36 STEEL

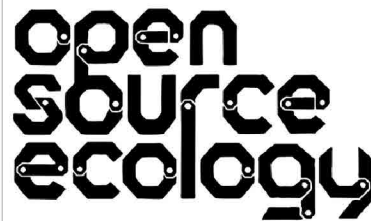
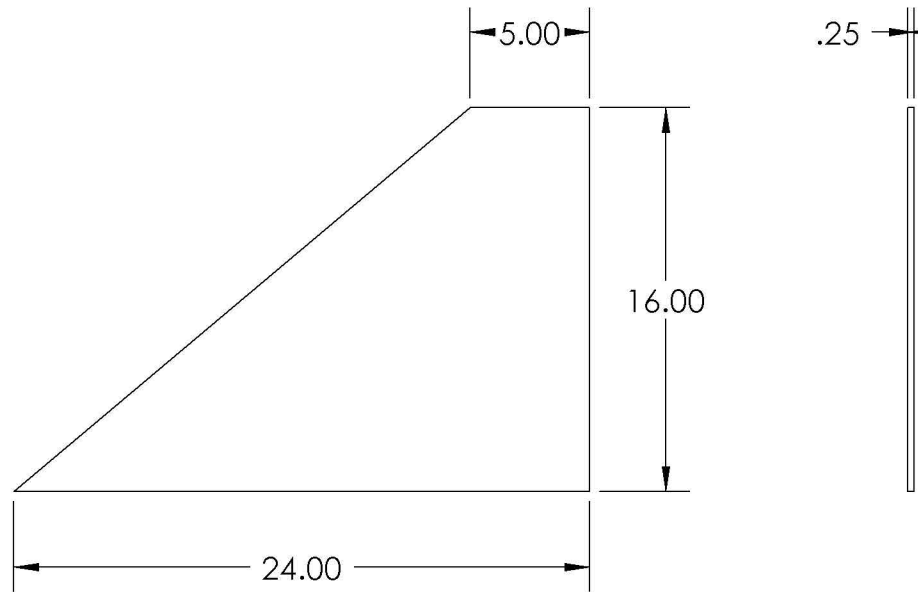

LICENSE INFORMATION
 ALL INFORMATION IS RELEASED UNDER THE OSE
 LICENSE FOR DISTRIBUTIVE ECONOMICS. FOR
 FURTHER INFORMATION GO TO:
OPENSOURCEECOLOGY.ORG/WIKI/LICENSE

	NAME	DATE
DRAWN	MA	2011-12-22
CHECKED		YYYY/MM/DD
APPR.		YYYY/MM/DD
UNLESS OTHERWISE SPECIFIED DIMENSIONS ARE IN INCHES		
ANGLES	.X	.XX
	± .5	± .1
		± .03
		± .005

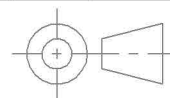

THIRD ANGLE PROJECTION

PROJECT:
PULVERIZER

DESCRIPTION:
SIDE PLATES

SIZE DWG. NO.
A 100505

REV
A

SCALE: 1:8

WEIGHT: 16.5LBS

SHEET 1 OF 1

NOTES:

- MATERIAL:
ASTM A36 STEEL

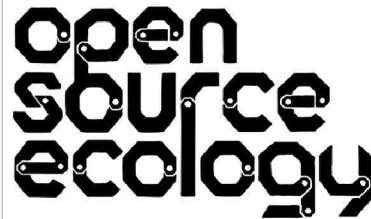
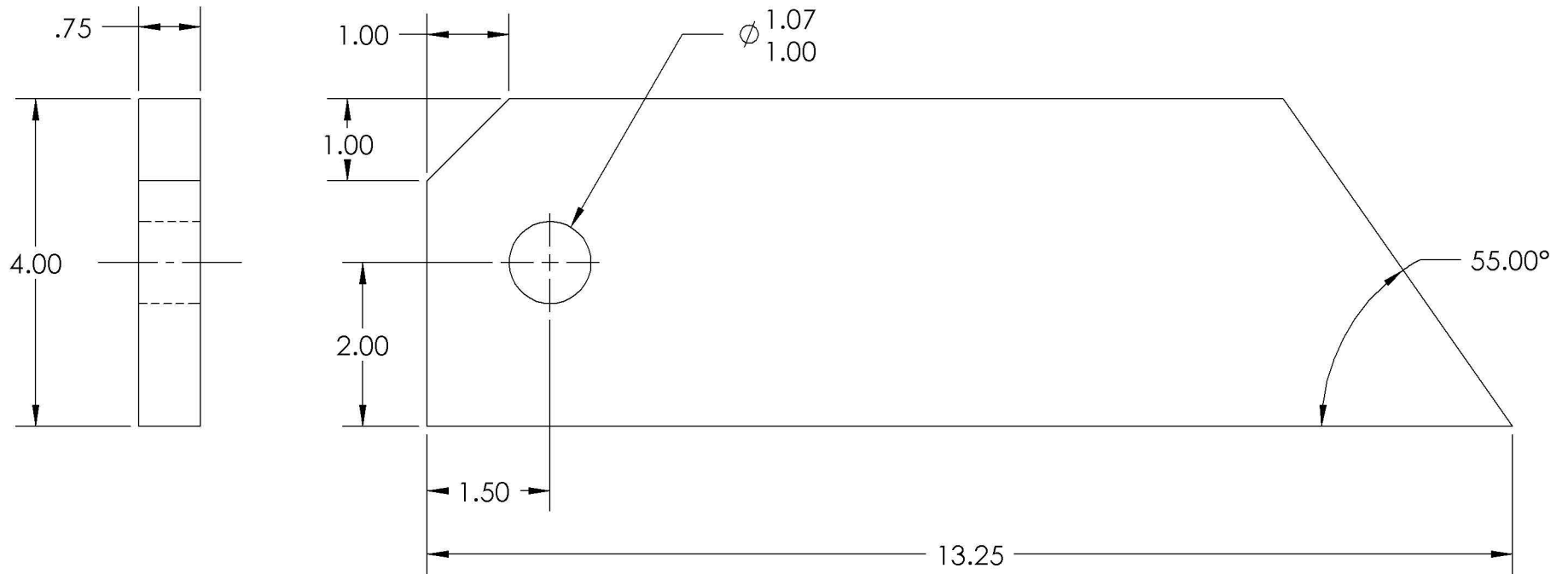

LICENSE INFORMATION
 ALL INFORMATION IS RELEASED UNDER THE OSE
 LICENSE FOR DISTRIBUTIVE ECONOMICS. FOR
 FURTHER INFORMATION GO TO:
OPENSOURCEECOLOGY.ORG/WIKI/LICENSE

	NAME	DATE		
DRAWN	MA	2011-12-22		
CHECKED		YYYY/MM/DD		
APPR.		YYYY/MM/DD		
UNLESS OTHERWISE SPECIFIED DIMENSIONS ARE IN INCHES				
ANGLES	.X	.XX	.XXX	
	±.5	±.1	±.03	±.005

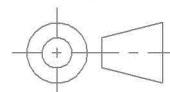

THIRD ANGLE PROJECTION

PROJECT: PULVERIZER	
DESCRIPTION: SIDE BRACE PLATE	
SIZE A	DWG. NO. 100506
SCALE: NONE	WEIGHT: 9.8LBS
SHEET 1 OF 1	
REV A	

NOTES:

- MATERIAL:
ASTM A36 STEEL

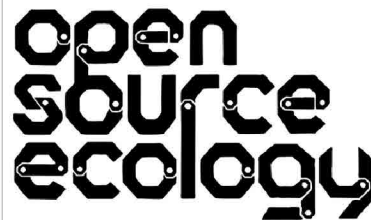
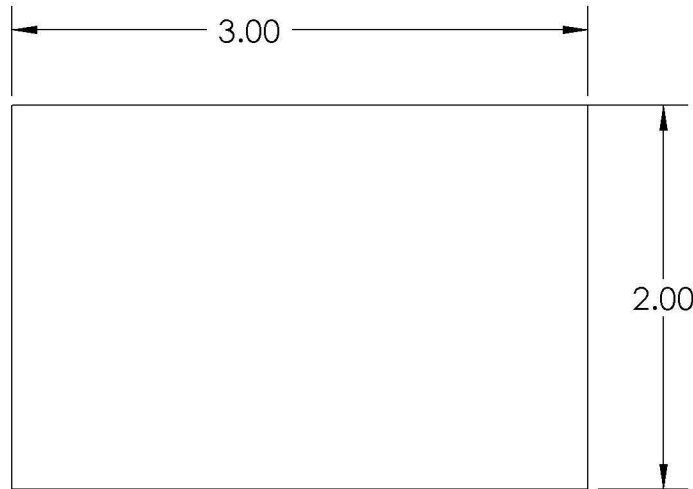
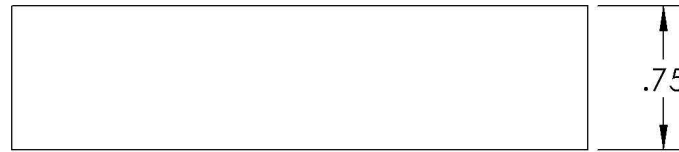

LICENSE INFORMATION
 ALL INFORMATION IS RELEASED UNDER THE OSE
 LICENSE FOR DISTRIBUTIVE ECONOMICS. FOR
 FURTHER INFORMATION GO TO:
OPENSOURCEECOLOGY.ORG/WIKI/LICENSE

	NAME	DATE		
DRAWN	MA	2011-12-22		
CHECKED		YYYY/MM/DD		
APPR.		YYYY/MM/DD		
UNLESS OTHERWISE SPECIFIED DIMENSIONS ARE IN INCHES				
ANGLES	.X	.XX	.XXX	
	± .5	± .1	± .03	± .005

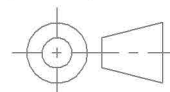

THIRD ANGLE PROJECTION

PROJECT:
PULVERIZER

DESCRIPTION:
HARD STOP PLATE

SIZE	DWG. NO.	REV
A	100507	A

SCALE: NONE	WEIGHT: 1.3LBS	SHEET 1 OF 1
-------------	----------------	--------------

NOTES:

- MATERIAL:
ASTM A36 STEEL

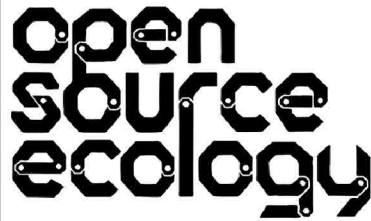
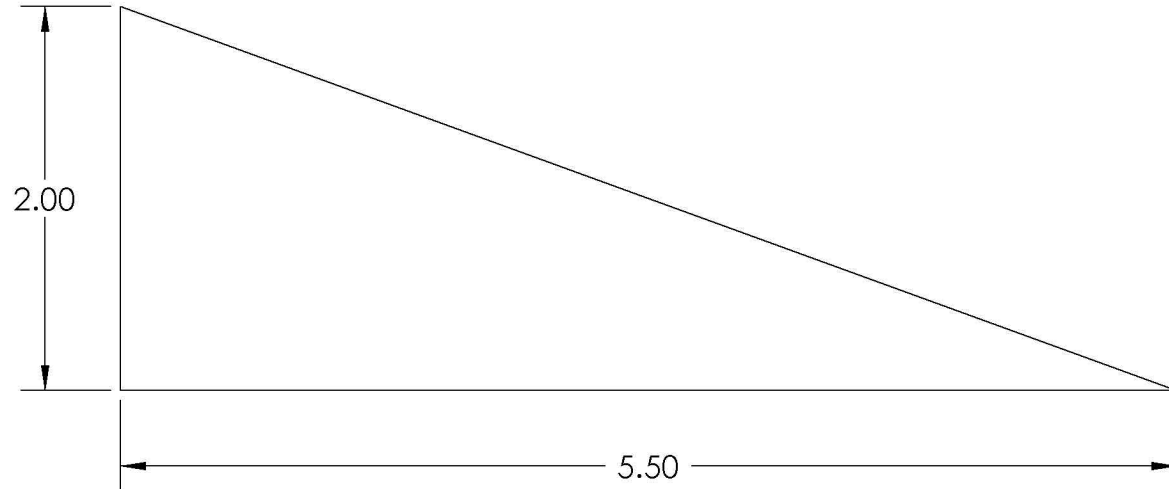
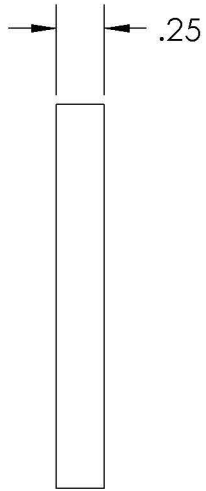

LICENSE INFORMATION
 ALL INFORMATION IS RELEASED UNDER THE OSE
 LICENSE FOR DISTRIBUTIVE ECONOMICS. FOR
 FURTHER INFORMATION GO TO:
OPENSOURCEECOLOGY.ORG/WIKI/LICENSE

	NAME	DATE
DRAWN	MA	2011-12-22
CHECKED		YYYY/MM/DD
APPR.		YYYY/MM/DD
UNLESS OTHERWISE SPECIFIED DIMENSIONS ARE IN INCHES		
ANGLES	.X	.XX
	± .5	± .1
		± .03
		± .005

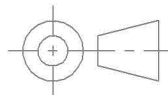

THIRD ANGLE PROJECTION

PROJECT: PULVERIZER	
DESCRIPTION: TRIANGLE PLATE	
SIZE A	DWG. NO. 100508
SCALE: NONE	WEIGHT: 0.4LBS
REV A	SHEET 1 OF 1

NOTES:

- MATERIAL:
ASTM A36 STEEL

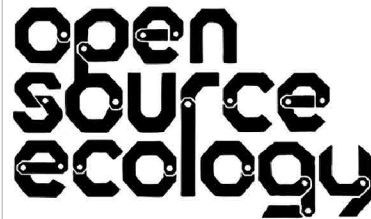
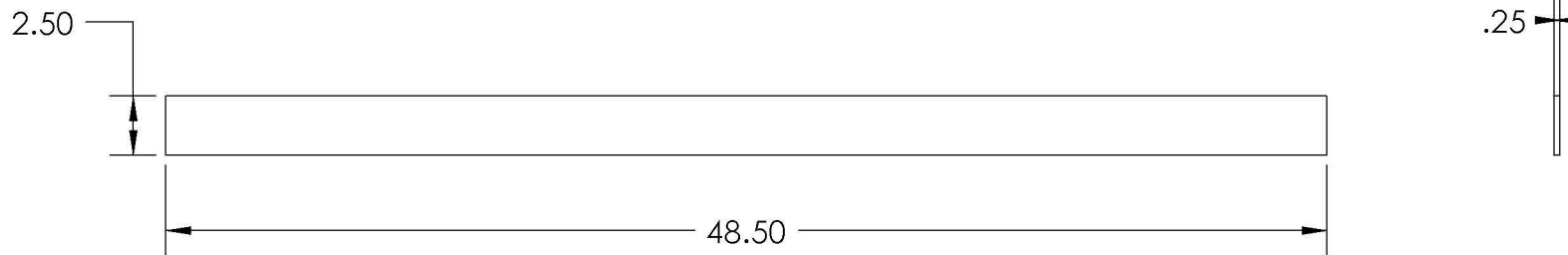

LICENSE INFORMATION
 ALL INFORMATION IS RELEASED UNDER THE OSE
 LICENSE FOR DISTRIBUTIVE ECONOMICS. FOR
 FURTHER INFORMATION GO TO:
OPENSOURCEECOLOGY.ORG/WIKI/LICENSE

	NAME	DATE
DRAWN	MA	2011-12-22
CHECKED		YYYY/MM/DD
APPR.		YYYY/MM/DD
UNLESS OTHERWISE SPECIFIED DIMENSIONS ARE IN INCHES		
ANGLES	.X	.XX
±.5	±.1	±.03
	.XXX	±.005

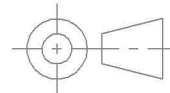

THIRD ANGLE PROJECTION

PROJECT:
PULVERIZER

DESCRIPTION:
**CROSS SUPPORT
PLATE**

SIZE	DWG. NO.	REV
A	100509	A

SCALE: NONE	WEIGHT: 8.6LBS	SHEET 1 OF 1
-------------	----------------	--------------

NOTES:

- MATERIAL:
ASTM A36 STEEL

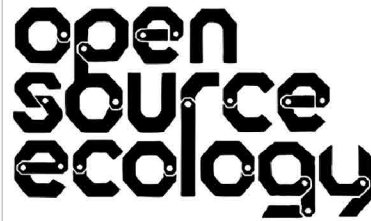
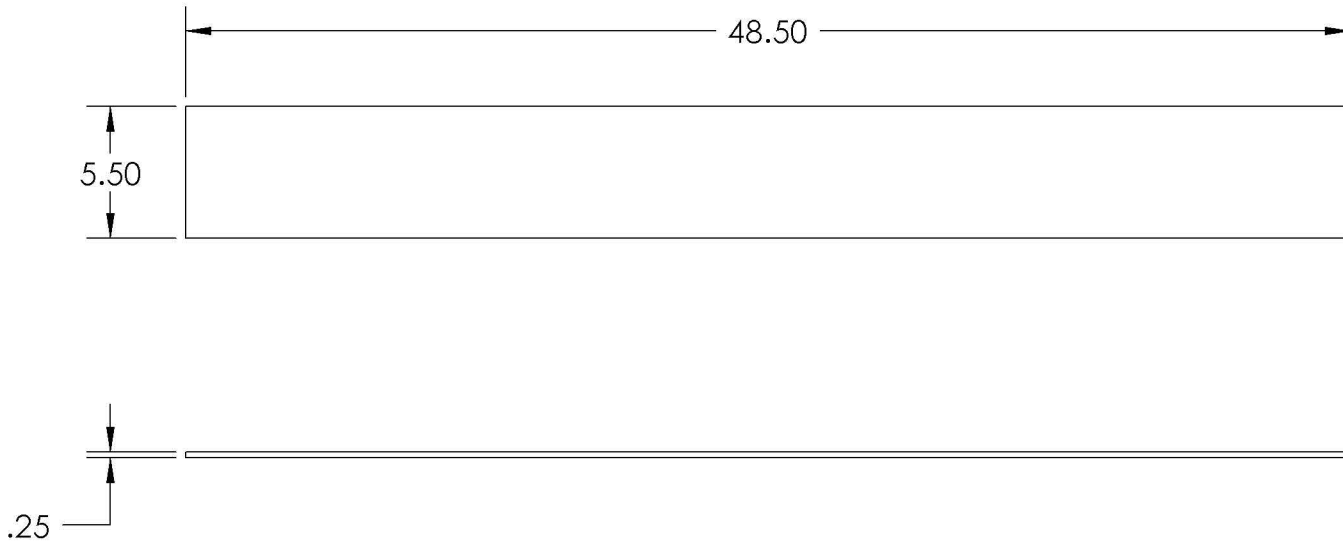

LICENSE INFORMATION
 ALL INFORMATION IS RELEASED UNDER THE OSE
 LICENSE FOR DISTRIBUTIVE ECONOMICS. FOR
 FURTHER INFORMATION GO TO:
OPENSOURCEECOLOGY.ORG/WIKI/LICENSE

	NAME	DATE		
DRAWN	MA	2011-12-22		
CHECKED		YYYY/MM/DD		
APPR.		YYYY/MM/DD		
UNLESS OTHERWISE SPECIFIED DIMENSIONS ARE IN INCHES				
ANGLES	.X	.XX	.XXX	
	± .5	± .1	± .03	± .005

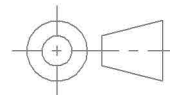

THIRD ANGLE PROJECTION

PROJECT:
PULVERIZER

DESCRIPTION:
**CROSS SUPPORT
PLATE LOWER**

SIZE DWG. NO.
A 100510

REV
A

SCALE: NONE WEIGHT: 18.9LBS SHEET 1 OF 1

NOTES:

- MATERIAL:
ASTM A36 STEEL

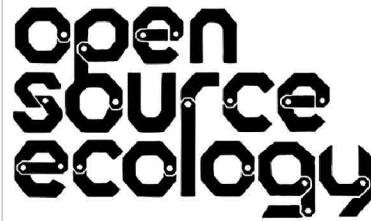
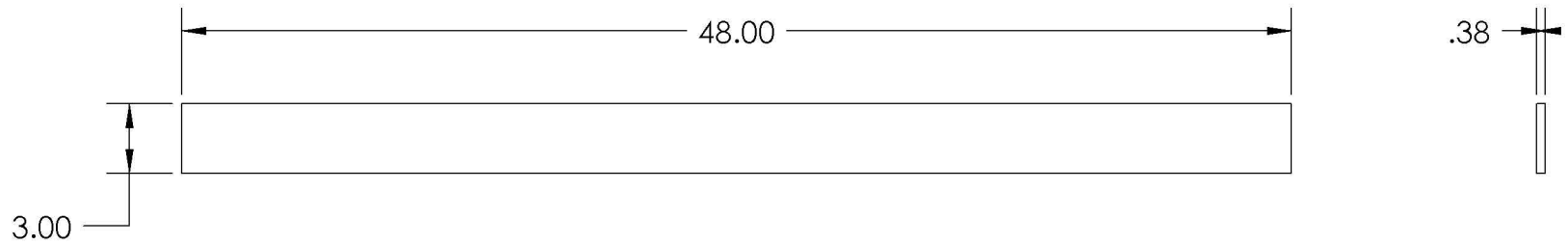

LICENSE INFORMATION
 ALL INFORMATION IS RELEASED UNDER THE OSE
 LICENSE FOR DISTRIBUTIVE ECONOMICS. FOR
 FURTHER INFORMATION GO TO:
OPENSOURCEECOLOGY.ORG/WIKI/LICENSE

	NAME	DATE
DRAWN	MA	2011-12-22
CHECKED		YYYY/MM/DD
APPR.		YYYY/MM/DD
UNLESS OTHERWISE SPECIFIED DIMENSIONS ARE IN INCHES		
ANGLES	.X	.XX
	±.5	±.1
		±.03
		±.005

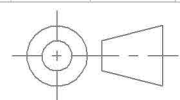

THIRD ANGLE PROJECTION

PROJECT: PULVERIZER	
DESCRIPTION: REAR MOUNTING PLATE	
SIZE A	DWG. NO. 100511
SCALE: NONE	WEIGHT: 16.0LBS
SHEET 1 OF 1	
REV A	

NOTES:

- MATERIAL:
ASTM A36 STEEL

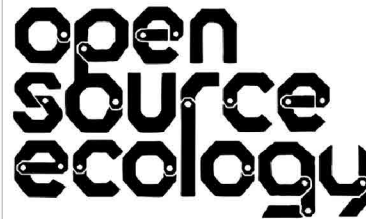
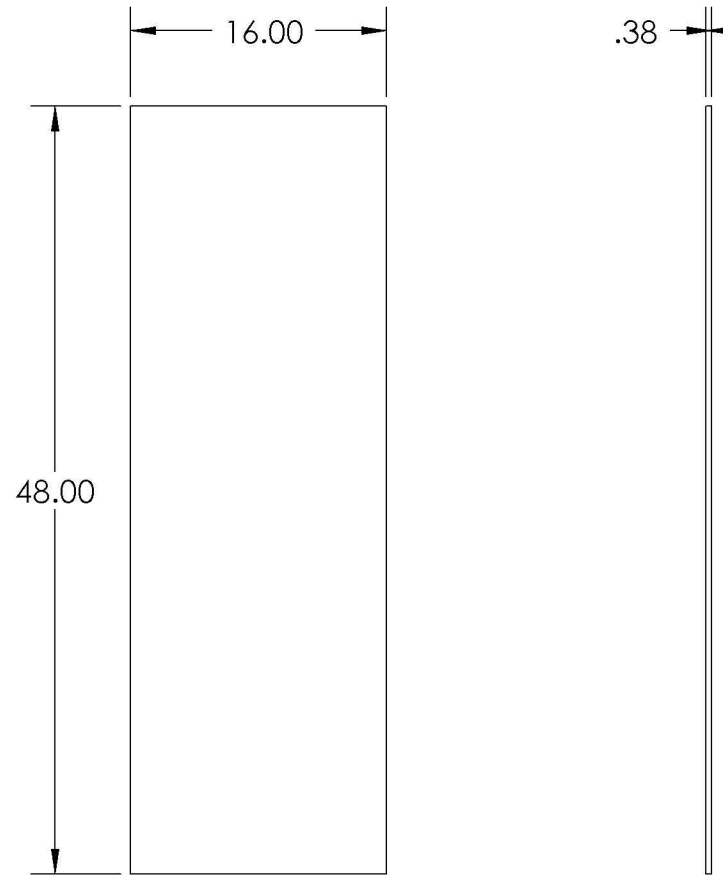
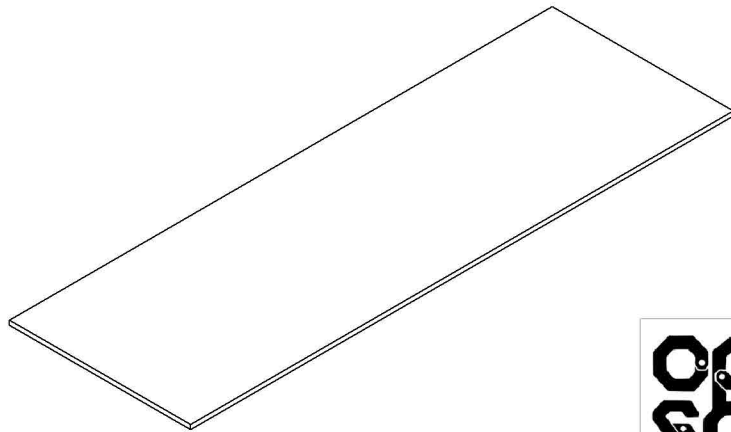

LICENSE INFORMATION
 ALL INFORMATION IS RELEASED UNDER THE OSE
 LICENSE FOR DISTRIBUTIVE ECONOMICS. FOR
 FURTHER INFORMATION GO TO:
OPENSOURCEECOLOGY.ORG/WIKI/LICENSE

	NAME	DATE
DRAWN	MA	2011-12-22
CHECKED		YYYY/MM/DD
APPR.		YYYY/MM/DD
UNLESS OTHERWISE SPECIFIED DIMENSIONS ARE IN INCHES		
ANGLES	.X	.XX
	±.5	±.1
		±.03
		±.005

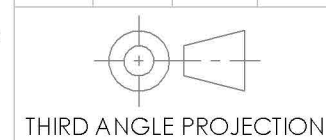

PROJECT:
PULVERIZER

DESCRIPTION:
BACK PLATE

SIZE	DWG. NO.	REV
A	100512	A
SCALE: NONE	WEIGHT: 81.7LBS	SHEET 1 OF 1

NOTES:

- MATERIAL:
ASTM A36 STEEL

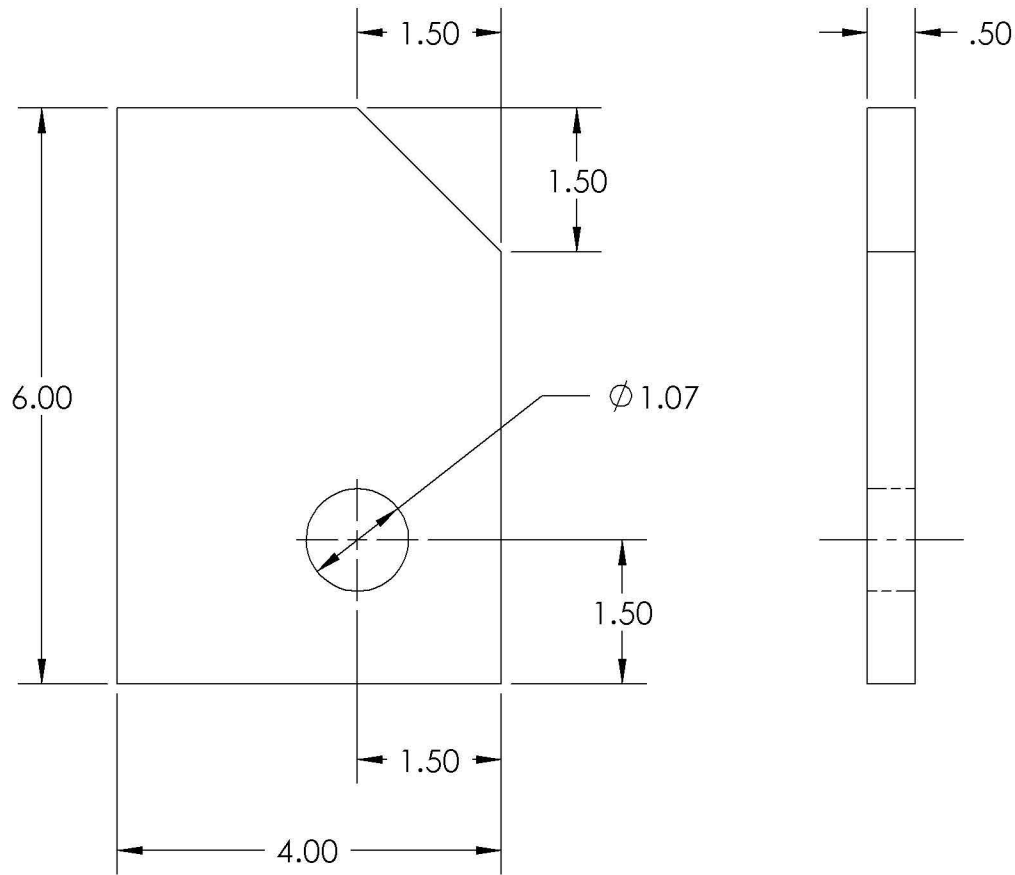
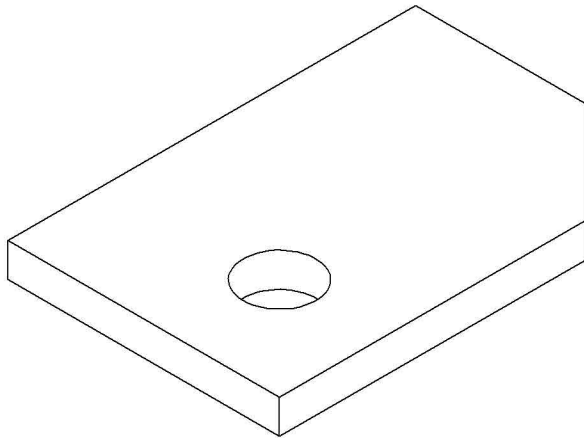

LICENSE INFORMATION
 ALL INFORMATION IS RELEASED UNDER THE OSE
 LICENSE FOR DISTRIBUTIVE ECONOMICS. FOR
 FURTHER INFORMATION GO TO:
OPENSOURCEECOLOGY.ORG/WIKI/LICENSE

	NAME	DATE
DRAWN	MA	2011-12-22
CHECKED		YYYY/MM/DD
APPR.		YYYY/MM/DD
UNLESS OTHERWISE SPECIFIED DIMENSIONS ARE IN INCHES		
ANGLES	.X	.XX
	±.5	±.1
		±.03
		±.005

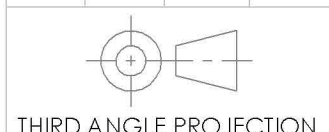

PROJECT:
PULVERIZER

DESCRIPTION:
**BOTTOM
MOUNTING PLATES**

SIZE DWG. NO. REV
A 100513 A

SCALE: NONE WEIGHT: 3.12LBS SHEET 1 OF 1

NOTES:

- MATERIAL:
ASTM A36 STEEL

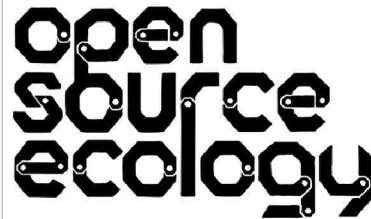
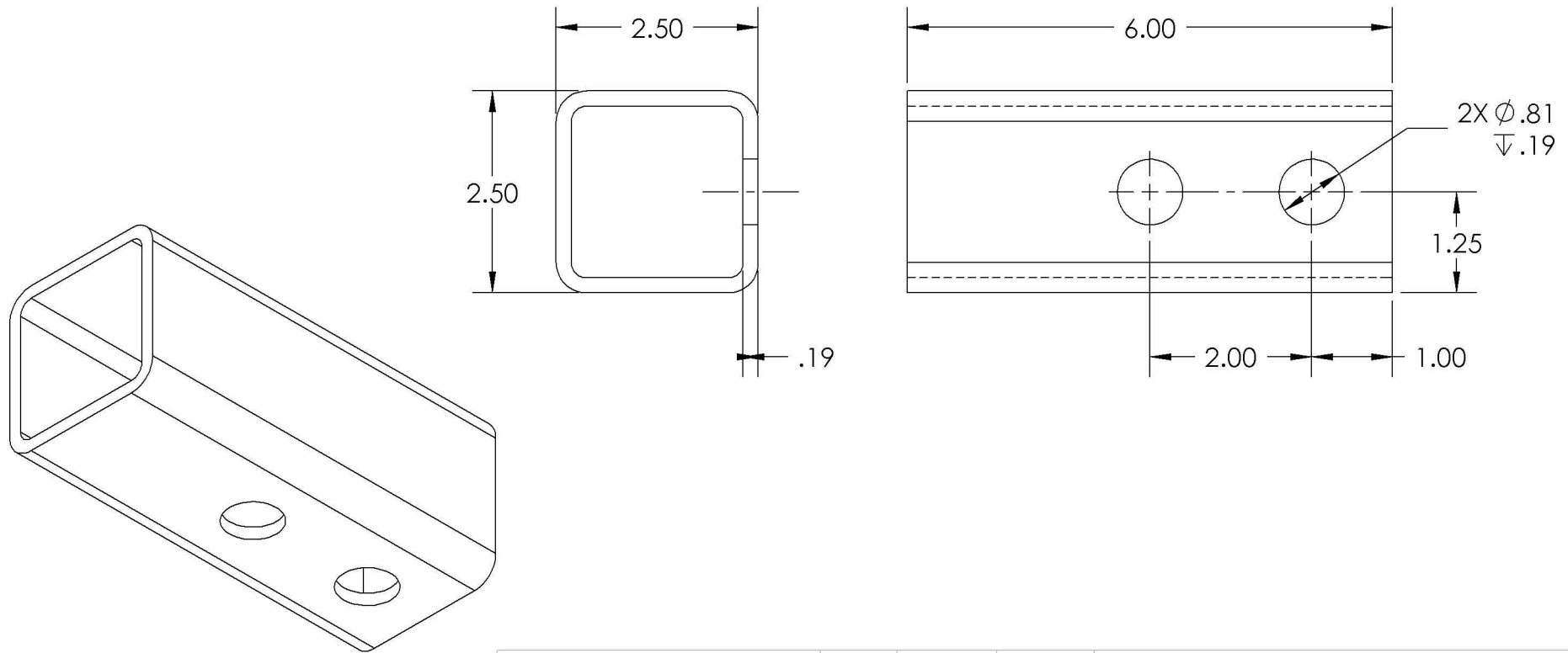

LICENSE INFORMATION
 ALL INFORMATION IS RELEASED UNDER THE OSE
 LICENSE FOR DISTRIBUTIVE ECONOMICS. FOR
 FURTHER INFORMATION GO TO:
OPENSOURCEECOLOGY.ORG/WIKI/LICENSE

	NAME	DATE
DRAWN	MA	2011-12-22
CHECKED		YYYY/MM/DD
APPR.		YYYY/MM/DD
UNLESS OTHERWISE SPECIFIED DIMENSIONS ARE IN INCHES		
ANGLES	.X	.XX
	±.5	±.1
		±.03
		±.005

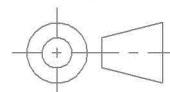

THIRD ANGLE PROJECTION

PROJECT: PULVERIZER		DESCRIPTION: LARGE TUBE, ANGLED
SIZE	DWG. NO. A 100514	
SCALE: NONE	WEIGHT: 2.74LBS	REV A
SHEET 1 OF 1		

NOTES:

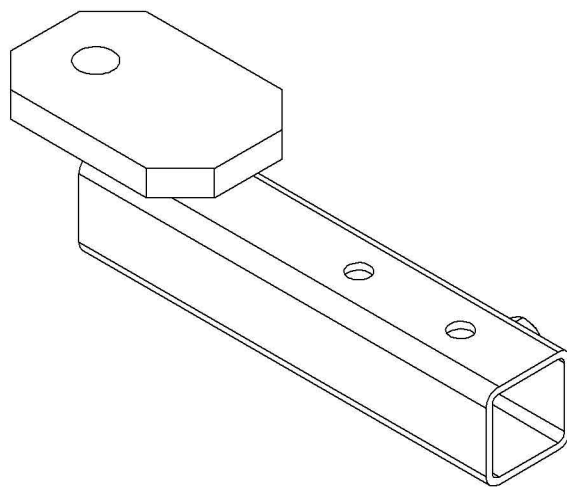
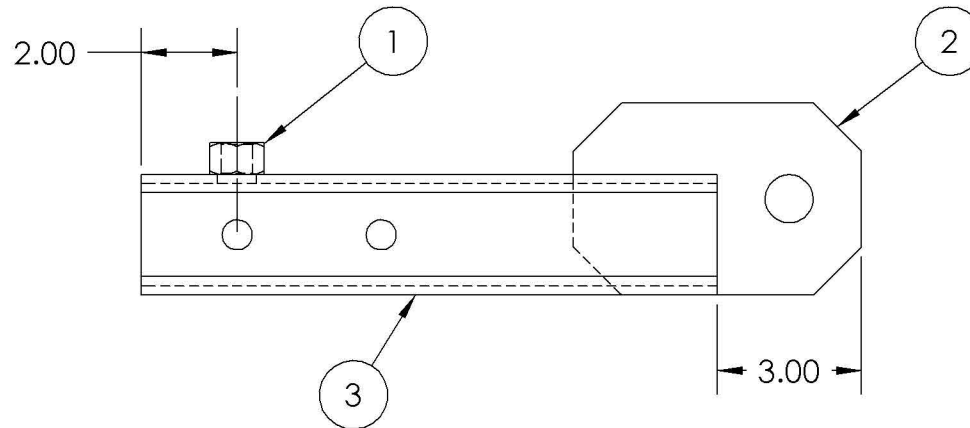
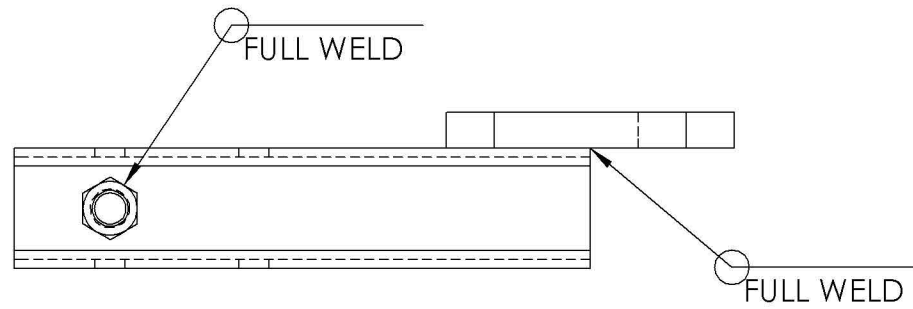

ITEM NO.	PART NUMBER	DESCRIPTION	QTY.
1	HNUT 0.7500-10-D-Steel	Nut, Hex, Steel, 0.75"x10	1
2	100516	JOINT PLATE	1
3	100517	LARGE TUBE	1

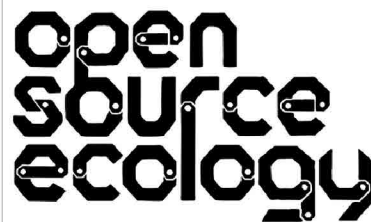

LICENSE INFORMATION
 ALL INFORMATION IS RELEASED UNDER THE OSE LICENSE FOR DISTRIBUTIVE ECONOMICS. FOR FURTHER INFORMATION GO TO:
OPENSOURCEECOLOGY.ORG/WIKI/LICENSE

	NAME	DATE
DRAWN	MA	2011-12-22
CHECKED		YYYY/MM/DD
APPR.		YYYY/MM/DD

UNLESS OTHERWISE SPECIFIED
 DIMENSIONS ARE IN INCHES

ANGLES	.X	.XX	.XXX
±.5	±.1	±.03	±.005

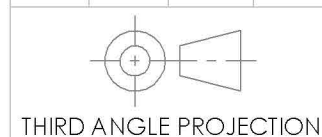

PROJECT:
PULVERIZER

DESCRIPTION:
**PIVOT WELDMENT,
 LEFT**

SIZE	DWG. NO.	REV
A	100515	A
SCALE: NONE	WEIGHT: 35.8LBS	SHEET 1 OF 1

NOTES:

- MATERIAL:
ASTM A36 STEEL

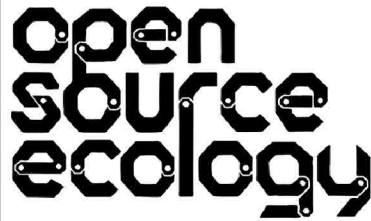
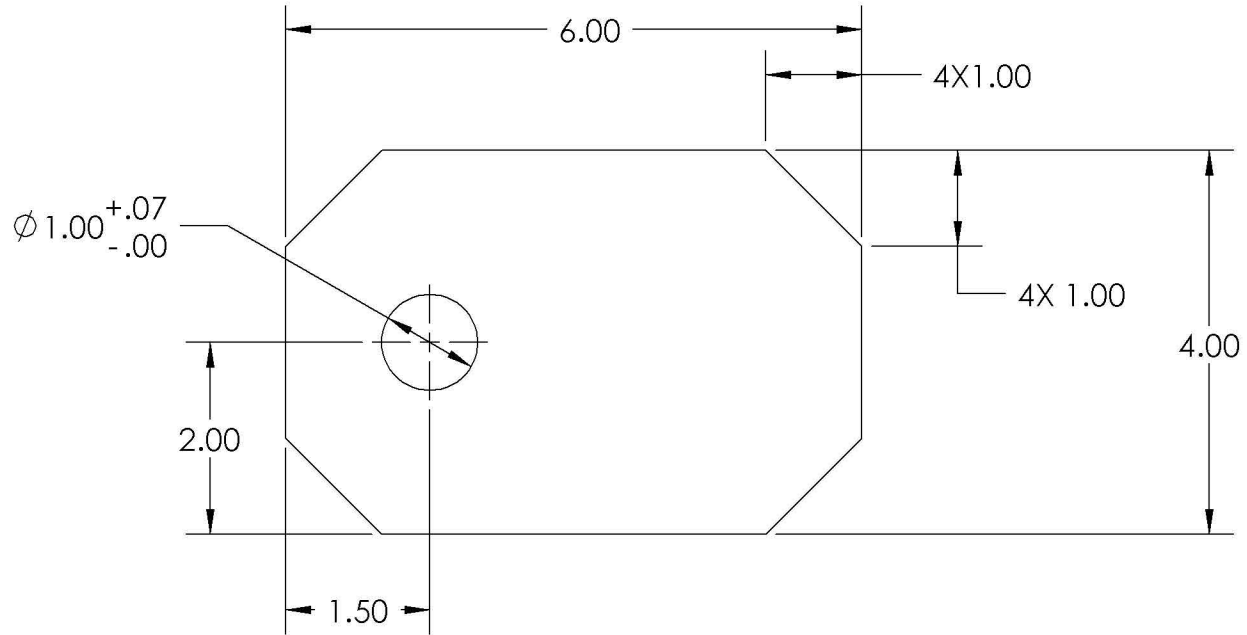
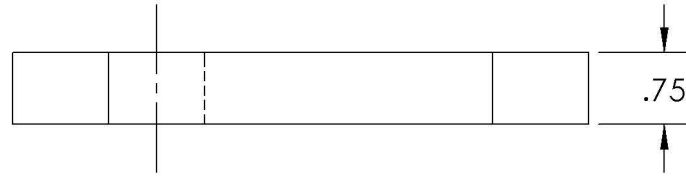

LICENSE INFORMATION
 ALL INFORMATION IS RELEASED UNDER THE OSE
 LICENSE FOR DISTRIBUTIVE ECONOMICS. FOR
 FURTHER INFORMATION GO TO:
OPENSOURCEECOLOGY.ORG/WIKI/LICENSE

	NAME	DATE
DRAWN	MA	2011-12-22
CHECKED		YYYY/MM/DD
APPR.		YYYY/MM/DD
UNLESS OTHERWISE SPECIFIED DIMENSIONS ARE IN INCHES		
ANGLES	.X	.XX
	± .5	± .1
		± .03
		± .005

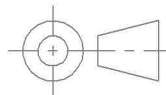

THIRD ANGLE PROJECTION

PROJECT:
PULVERIZER

DESCRIPTION:
JOINT PLATE

SIZE DWG. NO.
A 100516

REV
A

SCALE: NONE WEIGHT: 4.51LBS SHEET 1 OF 1

NOTES:

- MATERIAL:
ASTM A36 STEEL

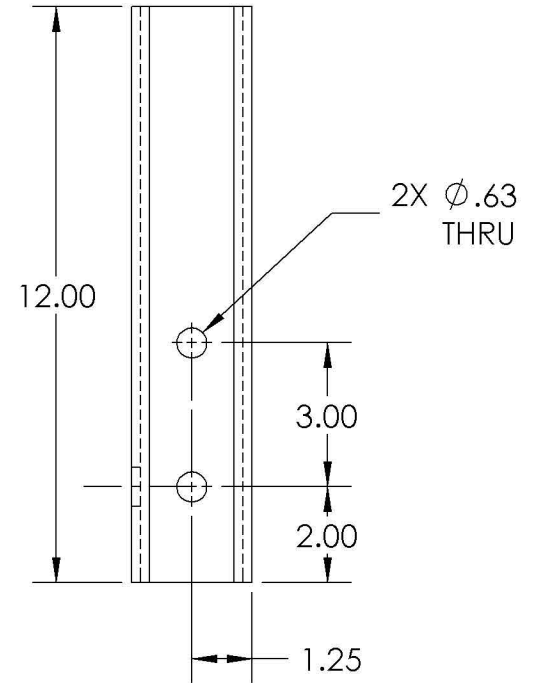
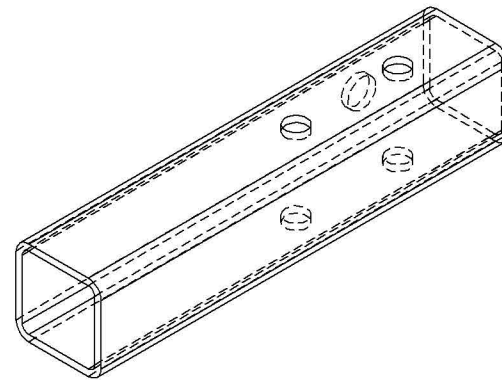
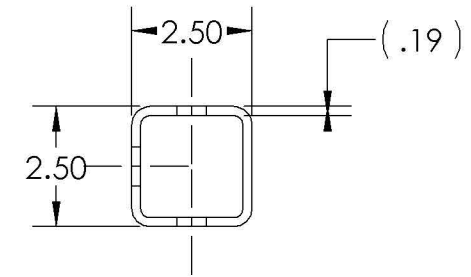
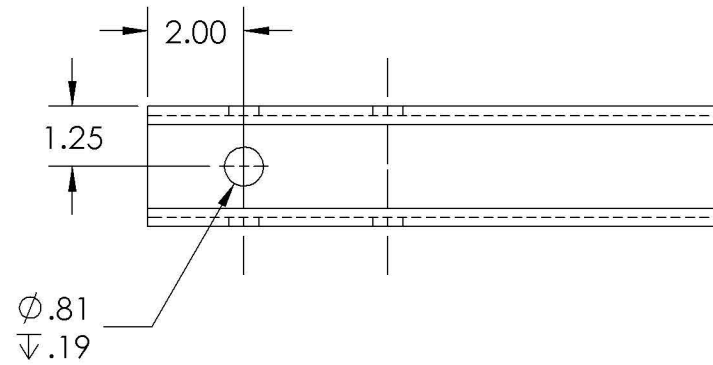

LICENSE INFORMATION
ALL INFORMATION IS RELEASED UNDER THE OSE LICENSE FOR DISTRIBUTIVE ECONOMICS. FOR FURTHER INFORMATION GO TO:
OPENSOURCEECOLOGY.ORG/WIKI/LICENSE

	NAME	DATE
DRAWN	MA	2011-12-22
CHECKED		YYYY/MM/DD
APPR.		YYYY/MM/DD
UNLESS OTHERWISE SPECIFIED DIMENSIONS ARE IN INCHES		
ANGLES	.X	.XX
	±.5	±.1
		±.03
		±.005

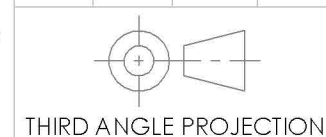

PROJECT:
PULVERIZER

DESCRIPTION:
LARGE TUBE

SIZE	DWG. NO.	REV
A	100517	A
SCALE: NONE	WEIGHT: 5.50LBS	SHEET 1 OF 1

NOTES:

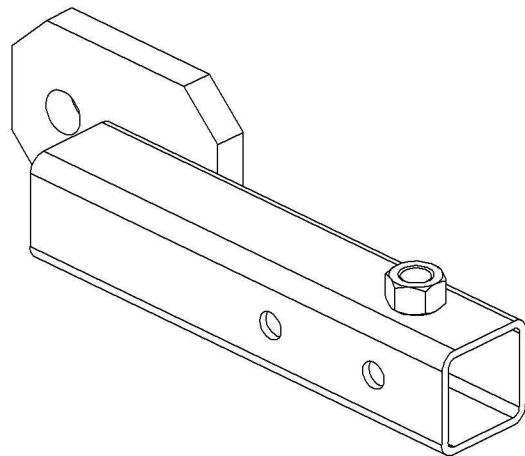
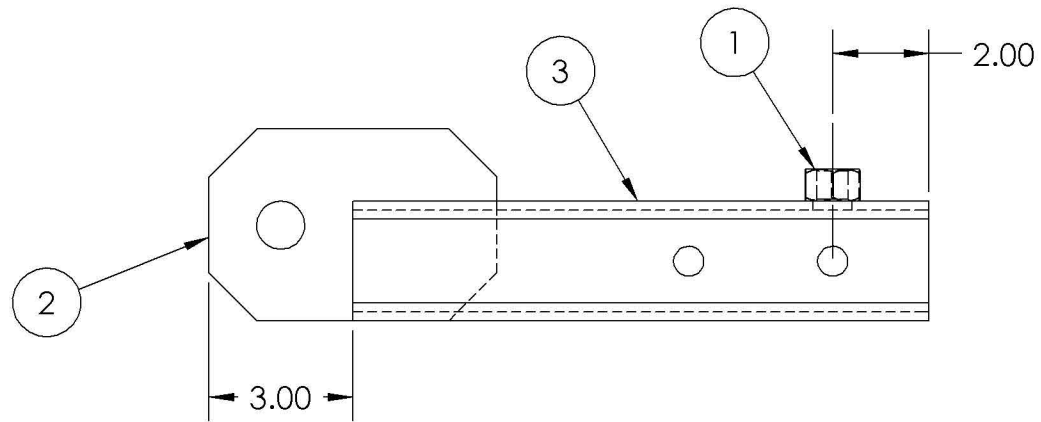
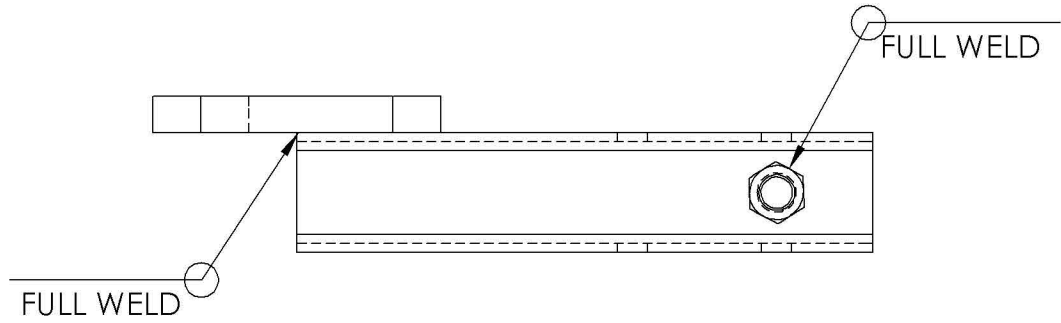

ITEM NO.	PART NUMBER	DESCRIPTION	QTY.
1	HNUT 0.7500-10-D-Steel	Nut, Hex, Steel, 0.75"x10	1
2	100516	JOINT PLATE	1
3	100517	LARGE TUBE	1



LICENSE INFORMATION
 ALL INFORMATION IS RELEASED UNDER THE OSE LICENSE FOR DISTRIBUTIVE ECONOMICS. FOR FURTHER INFORMATION GO TO:
OPENSOURCEECOLOGY.ORG/WIKI/LICENSE

	NAME	DATE
DRAWN	MA	2011-12-22
CHECKED		YYYY/MM/DD
APPR.		YYYY/MM/DD

UNLESS OTHERWISE SPECIFIED DIMENSIONS ARE IN INCHES

ANGLES	.X	.XX	.XXX
±.5	±.1	±.03	±.005

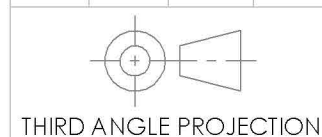

PROJECT: PULVERIZER		REV A
DESCRIPTION: PIVOT WELDMENT, RIGHT		
SIZE A	DWG. NO. 100518	
SCALE: NONE	WEIGHT: 35.8LBS	SHEET 1 OF 1

NOTES:

- MATERIAL:
ASTM A36 STEEL

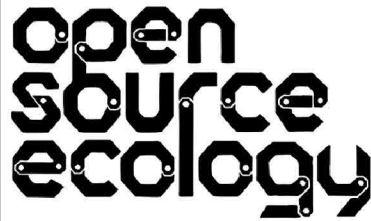
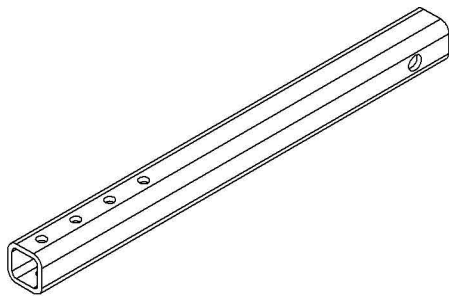
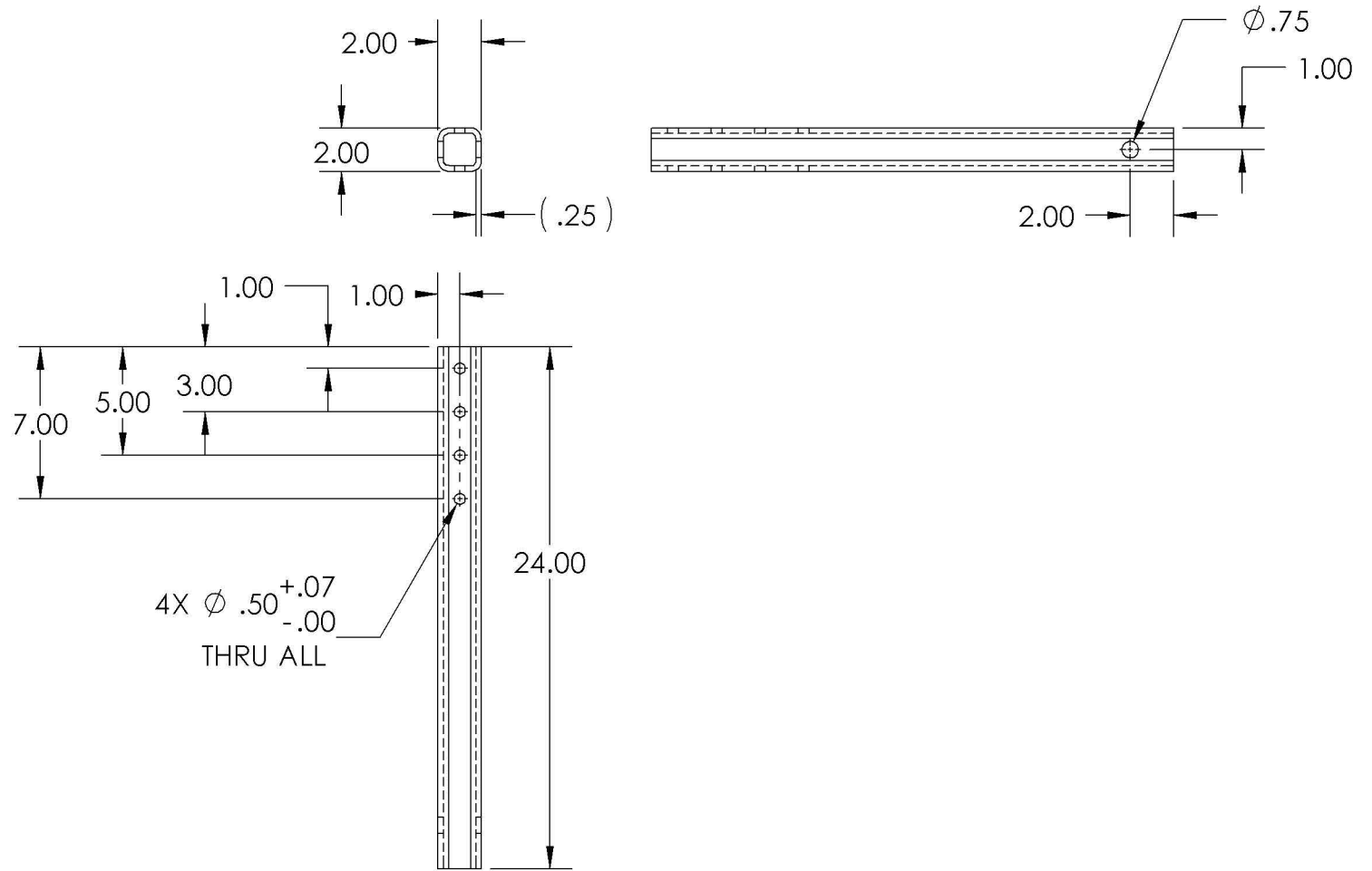

LICENSE INFORMATION
 ALL INFORMATION IS RELEASED UNDER THE OSE LICENSE FOR DISTRIBUTIVE ECONOMICS. FOR FURTHER INFORMATION GO TO:
OPENSOURCEECOLOGY.ORG/WIKI/LICENSE

	NAME	DATE
DRAWN	MA	2011-12-22
CHECKED		YYYY/MM/DD
APPR.		YYYY/MM/DD
UNLESS OTHERWISE SPECIFIED DIMENSIONS ARE IN INCHES		
ANGLES	.X	.XX
	$\pm .5$	$\pm .1$
		$\pm .03$
		$\pm .005$

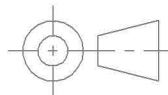

THIRD ANGLE PROJECTION

PROJECT: PULVERIZER	
DESCRIPTION: SMALL TUBE	
SIZE A	DWG. NO. 100521
SCALE: NONE	WEIGHT: 10.6LBS
SHEET 1 OF 1	
REV A	

NOTES:

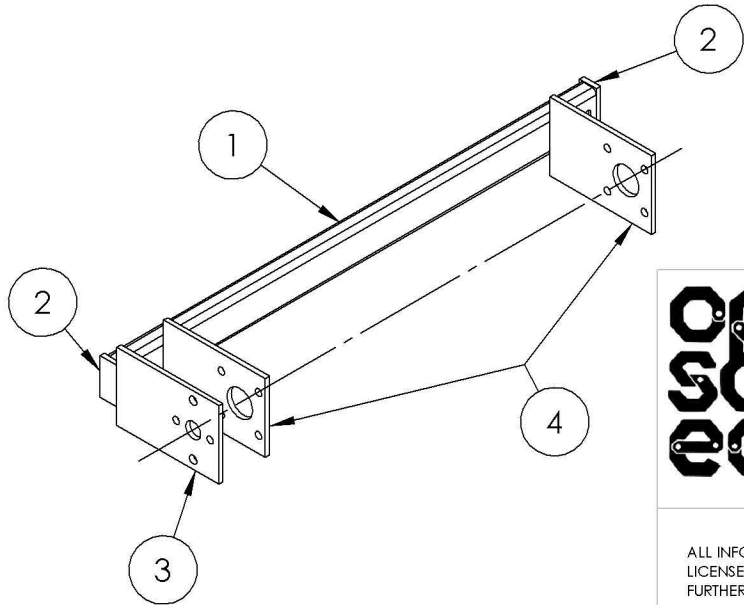
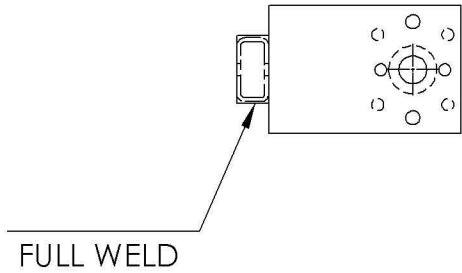
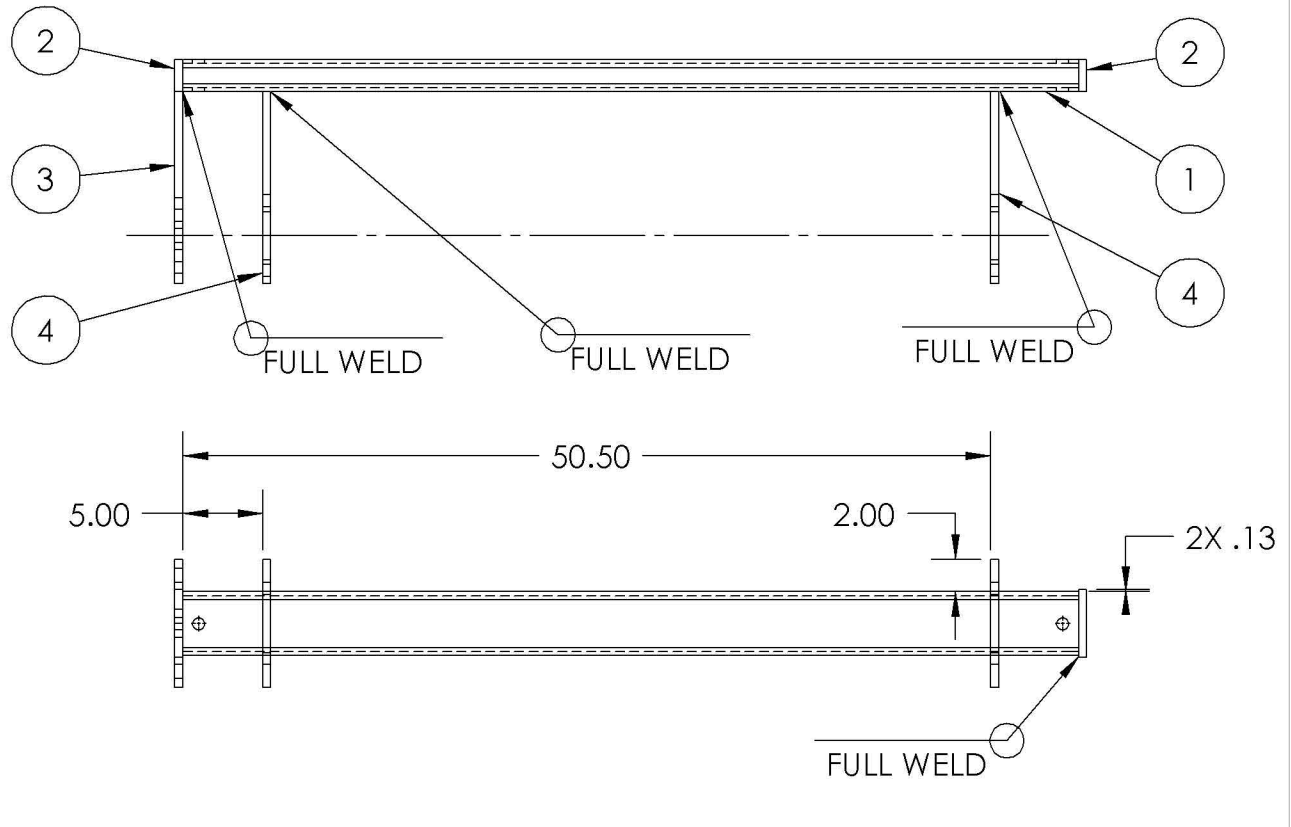

ITEM NO.	PART NUMBER	DESCRIPTION	QTY.
1	100523	CROSS TUBE	1
2	100524	END PLATE, CROSS TUBE	2
3	100525	PLATE, MOTOR END	1
4	100526	PLATE, BEARING	2

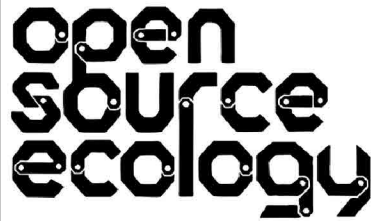

LICENSE INFORMATION
 ALL INFORMATION IS RELEASED UNDER THE OSE LICENSE FOR DISTRIBUTIVE ECONOMICS. FOR FURTHER INFORMATION GO TO:
OPENSOURCEECOLOGY.ORG/WIKI/LICENSE

NAME	DATE
DRAWN MA	2011-12-22
CHECKED	YYYY/MM/DD
APPR.	YYYY/MM/DD
UNLESS OTHERWISE SPECIFIED DIMENSIONS ARE IN INCHES	
ANGLES	.X .XX .XXX
±.5	±.1 ±.03 ±.005

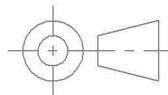

THIRD ANGLE PROJECTION

PROJECT:	PULVERIZER	
DESCRIPTION:	FRONT HOLDER WELDMENT	
SIZE	DWG. NO.	REV
A	100522	A
SCALE: NONE	WEIGHT: 81.1LBS	SHEET 1 OF 1

NOTES:

- MATERIAL:
ASTM A36 STEEL

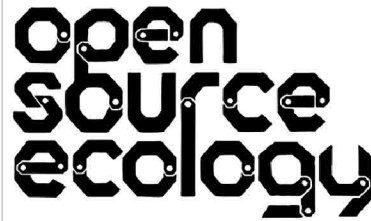
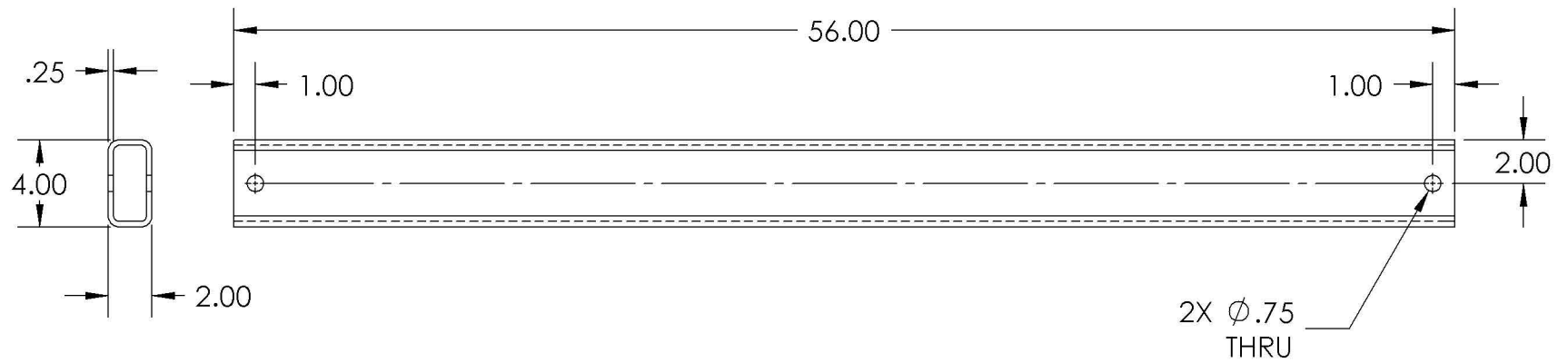

LICENSE INFORMATION
 ALL INFORMATION IS RELEASED UNDER THE OSE
 LICENSE FOR DISTRIBUTIVE ECONOMICS. FOR
 FURTHER INFORMATION GO TO:
OPENSOURCEECOLOGY.ORG/WIKI/LICENSE

	NAME	DATE		
DRAWN	MA	2011-12-22		
CHECKED		YYYY/MM/DD		
APPR.		YYYY/MM/DD		
UNLESS OTHERWISE SPECIFIED DIMENSIONS ARE IN INCHES				
ANGLES	.X	.XX	.XXX	
	±.5	±.1	±.03	±.005

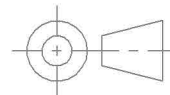

THIRD ANGLE PROJECTION

PROJECT: PULVERIZER	
DESCRIPTION: CROSS TUBE	
SIZE A	DWG. NO. 100523
SCALE: NONE	WEIGHT: 41.0LBS
SHEET 1 OF 1	
REV A	

NOTES:

- MATERIAL:
ASTM A36 STEEL

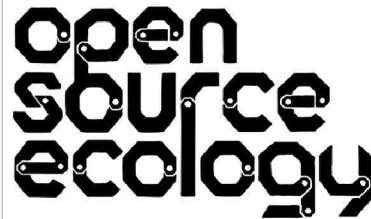
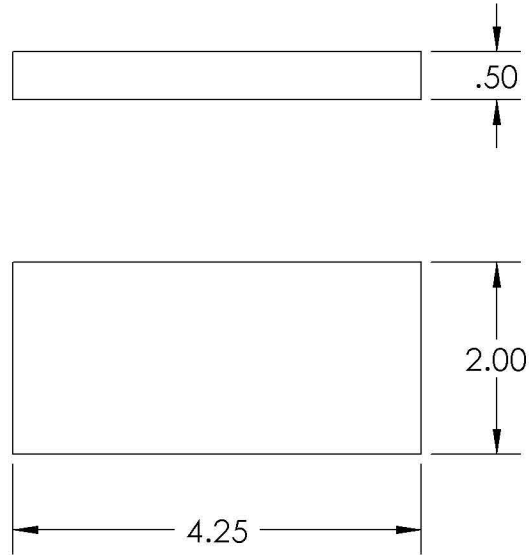

LICENSE INFORMATION
 ALL INFORMATION IS RELEASED UNDER THE OSE
 LICENSE FOR DISTRIBUTIVE ECONOMICS. FOR
 FURTHER INFORMATION GO TO:
OPENSOURCEECOLOGY.ORG/WIKI/LICENSE

	NAME	DATE
DRAWN	MA	2011-12-22
CHECKED		YYYY/MM/DD
APPR.		YYYY/MM/DD

UNLESS OTHERWISE SPECIFIED
 DIMENSIONS ARE IN INCHES

ANGLES	.X	.XX	.XXX
± .5	± .1	± .03	± .005

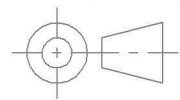

THIRD ANGLE PROJECTION

PROJECT: PULVERIZER	
DESCRIPTION: END PLATE, CROSS TUBE	
SIZE A	DWG. NO. 100524
SCALE: NONE	WEIGHT: 5.21LBS
REV A	SHEET 1 OF 1

NOTES:

- MATERIAL:
ASTM A36 STEEL

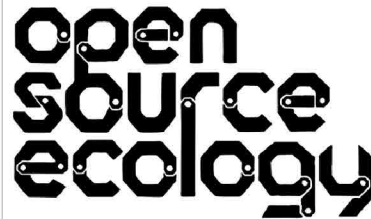
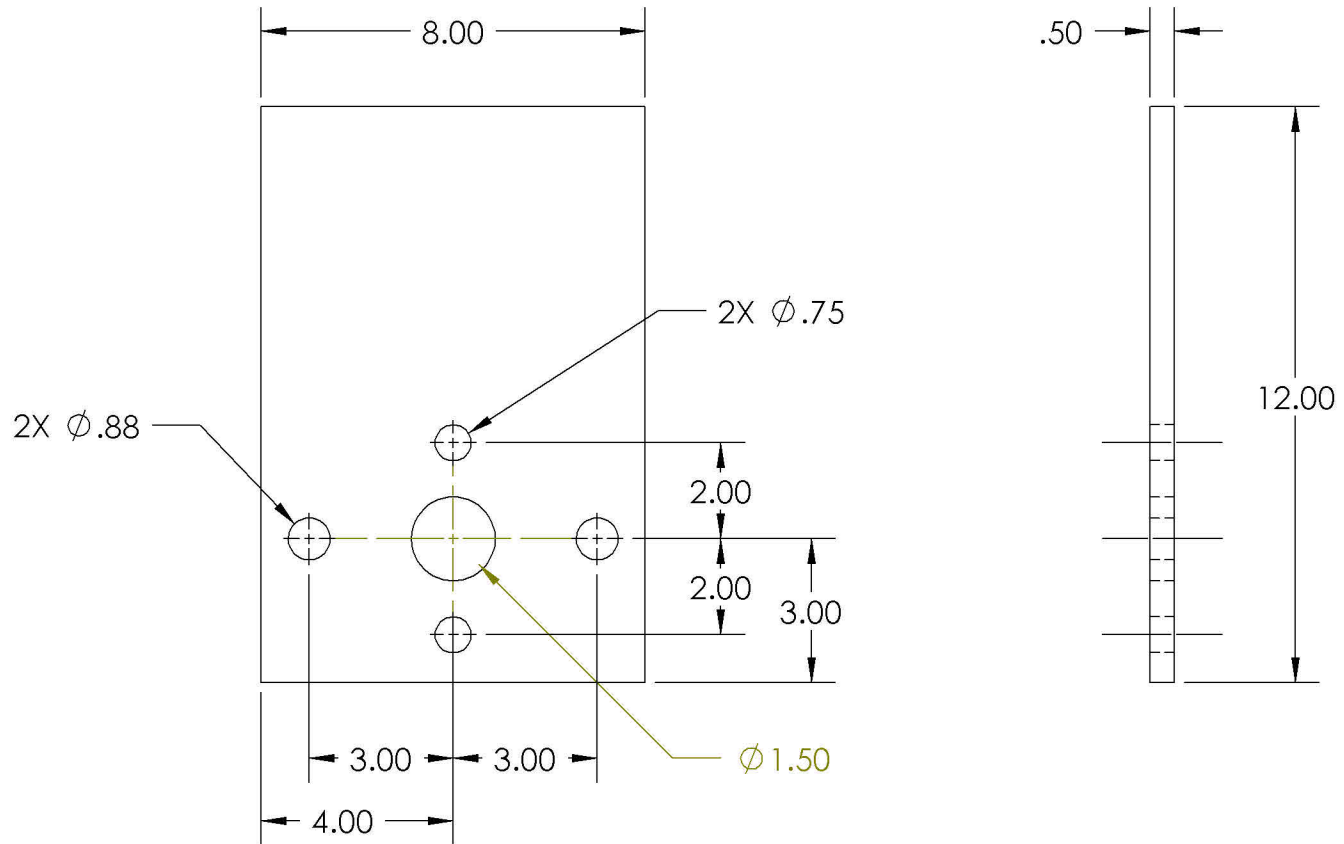

LICENSE INFORMATION
 ALL INFORMATION IS RELEASED UNDER THE OSE
 LICENSE FOR DISTRIBUTIVE ECONOMICS. FOR
 FURTHER INFORMATION GO TO:
OPENSOURCEECOLOGY.ORG/WIKI/LICENSE

	NAME	DATE
DRAWN	MA	2011-12-22
CHECKED		YYYY/MM/DD
APPR.		YYYY/MM/DD
UNLESS OTHERWISE SPECIFIED DIMENSIONS ARE IN INCHES		
ANGLES	.X	.XX
	±.5	±.1
		±.03
		±.005

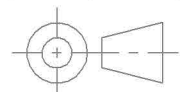

THIRD ANGLE PROJECTION

PROJECT: PULVERIZER	
DESCRIPTION: PLATE, MOTOR END	
SIZE A	DWG. NO. 100525
SCALE: NONE	WEIGHT: 13.0LBS
SHEET 1 OF 1	
REV A	

NOTES:

- MATERIAL:
ASTM A36 STEEL

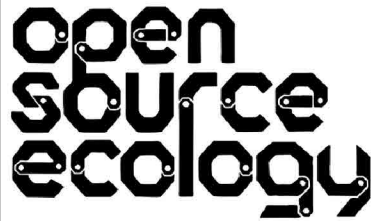
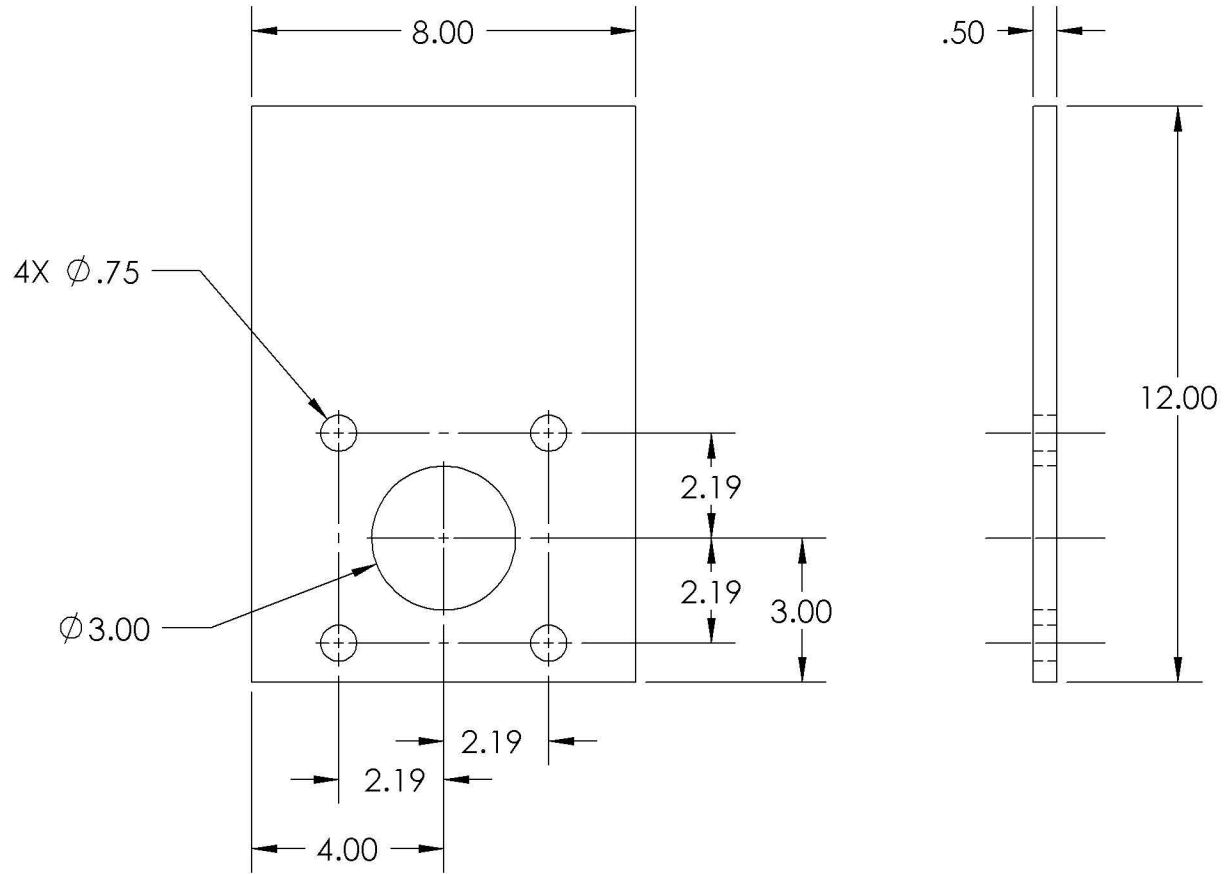

LICENSE INFORMATION
 ALL INFORMATION IS RELEASED UNDER THE OSE
 LICENSE FOR DISTRIBUTIVE ECONOMICS. FOR
 FURTHER INFORMATION GO TO:
OPENSOURCEECOLOGY.ORG/WIKI/LICENSE

	NAME	DATE
DRAWN	MA	2011-12-22
CHECKED		YYYY/MM/DD
APPR.		YYYY/MM/DD
UNLESS OTHERWISE SPECIFIED DIMENSIONS ARE IN INCHES		
ANGLES	.X	.XX
	±.5	±.1
		±.03
		±.005

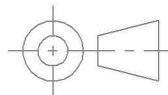

THIRD ANGLE PROJECTION

PROJECT:
PULVERIZER

DESCRIPTION:
PLATE, BEARING

SIZE	DWG. NO.	REV
A	100526	A

SCALE: NONE	WEIGHT: 12.4LBS	SHEET 1 OF 1
-------------	-----------------	--------------

NOTES:

- MATERIAL:
ASTM A36 STEEL

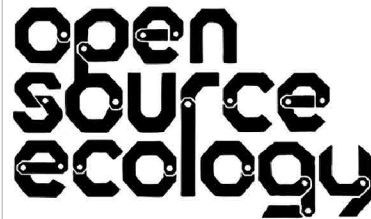
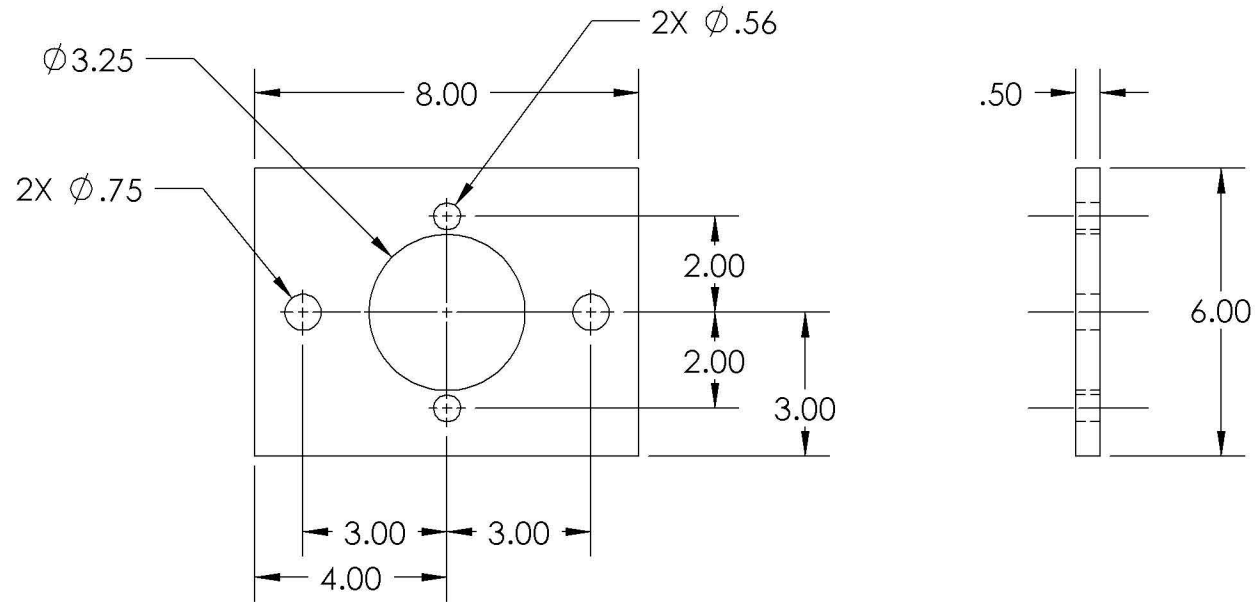

LICENSE INFORMATION
 ALL INFORMATION IS RELEASED UNDER THE OSE
 LICENSE FOR DISTRIBUTIVE ECONOMICS. FOR
 FURTHER INFORMATION GO TO:
OPENSOURCEECOLOGY.ORG/WIKI/LICENSE

	NAME	DATE
DRAWN	MA	2011-12-22
CHECKED		YYYY/MM/DD
APPR.		YYYY/MM/DD
UNLESS OTHERWISE SPECIFIED DIMENSIONS ARE IN INCHES		
ANGLES	.X	.XX
	±.5	±.1
		±.03
		±.005

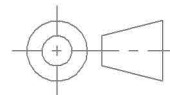

THIRD ANGLE PROJECTION

PROJECT:
PULVERIZER

DESCRIPTION:
**PLATE, MOTOR
MOUNT**

SIZE	DWG. NO.	REV
A	100527	A

SCALE: NONE | WEIGHT: 5.43LBS | SHEET 1 OF 1

NOTES:

1. MATERIAL:
ASTM A36 STEEL

2 THIS HOLE SHOULD BE DRILLED WITH SHAFT PLACED 2.125" INSIDE COUPLER PIPE (PN 100545) FROM BOTTOM DIMENSIONED EDGE ON THAT DRAWING. THIS ENSURES HOLE ON THIS PART AND HOLE ON SHAFT LINE UP, ALLOWING BOLT TO PASS THROUGH THEM.

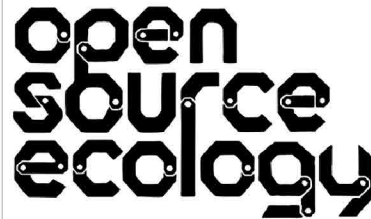
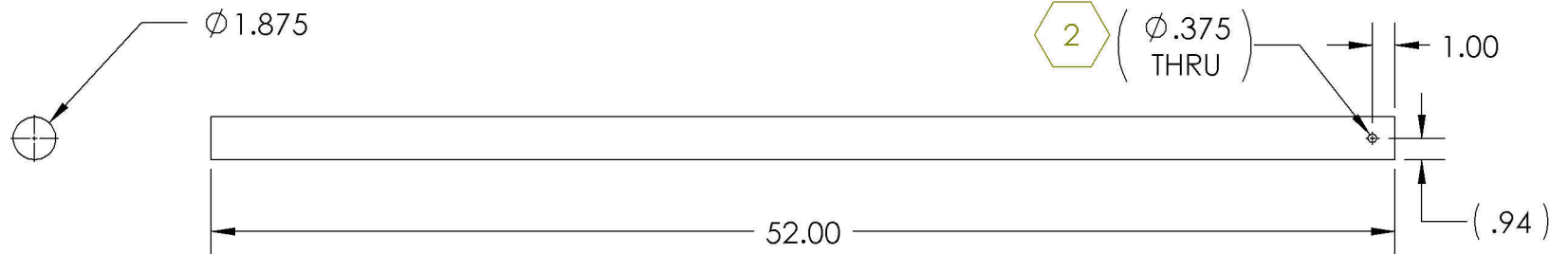

LICENSE INFORMATION
ALL INFORMATION IS RELEASED UNDER THE OSE LICENSE FOR DISTRIBUTIVE ECONOMICS. FOR FURTHER INFORMATION GO TO:
OPENSOURCEECOLOGY.ORG/WIKI/LICENSE

	NAME	DATE
DRAWN	MA	2011-12-22
CHECKED		YYYY/MM/DD
APPR.		YYYY/MM/DD
UNLESS OTHERWISE SPECIFIED DIMENSIONS ARE IN INCHES		
ANGLES	.X	.XX
±.5	±.1	±.03
		.XXX
		±.005

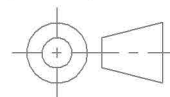

THIRD ANGLE PROJECTION

PROJECT: PULVERIZER		DESCRIPTION: SHAFT
SIZE	DWG. NO.	
A	100528	REV A
SCALE: NONE	WEIGHT: 40.7LBS	SHEET 1 OF 1

NOTES:

1. FILL WELD TINES (FN 2) TO PIPE (FN 1)
ALL AROUND AND TO EACHOTHER

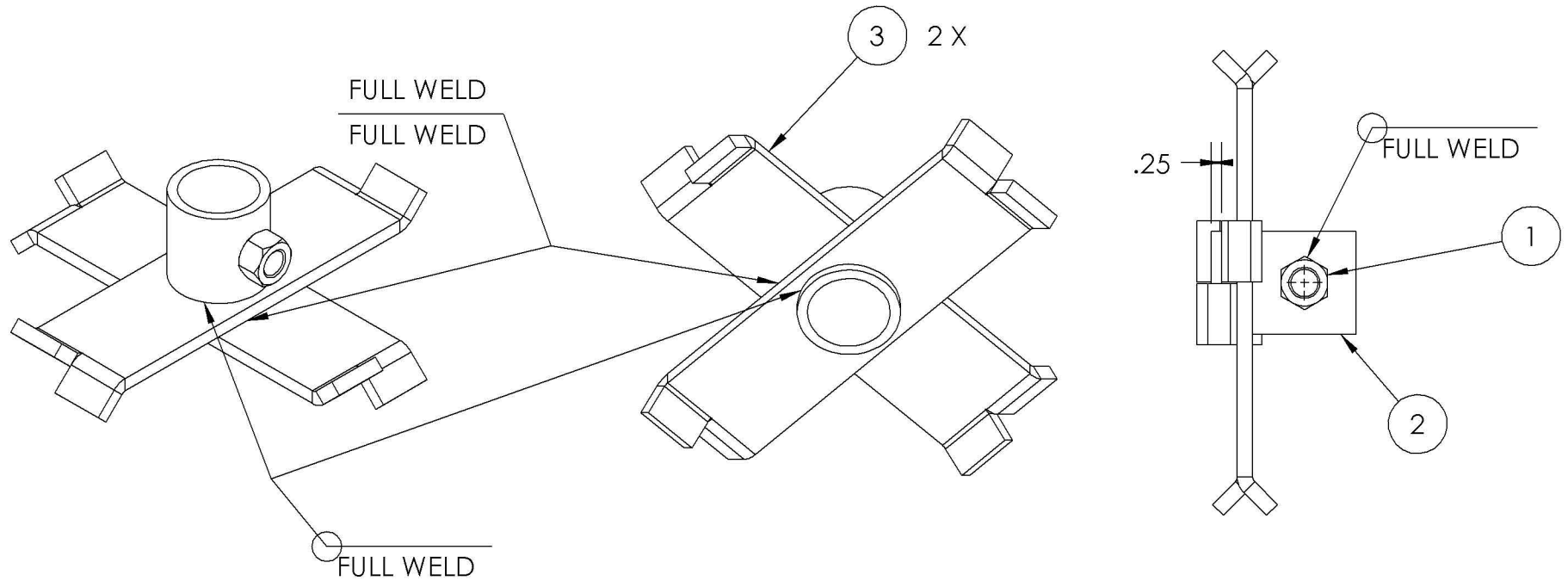

ITEM NO.	PART NUMBER	DESCRIPTION	QTY.
1	HNUT 0.7500-10-D-Steel	Nut, Hex, Steel, 0.75"x10	1
2	100530	TUBE, TINE	1
3	100542	TINE	2

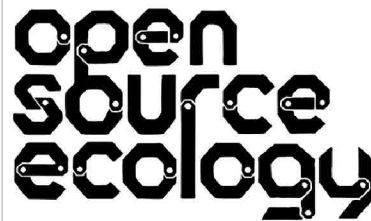

LICENSE INFORMATION
 ALL INFORMATION IS RELEASED UNDER THE OSE
 LICENSE FOR DISTRIBUTIVE ECONOMICS. FOR
 FURTHER INFORMATION GO TO:
OPENSOURCEECOLOGY.ORG/WIKI/LICENSE

	NAME	DATE
DRAWN	MA	2011-12-22
CHECKED		YYYY/MM/DD
APPR.		YYYY/MM/DD
UNLESS OTHERWISE SPECIFIED DIMENSIONS ARE IN INCHES		
ANGLES	.X	.XX
	±.5	±.1
		±.03
		±.005

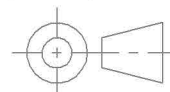

THIRD ANGLE PROJECTION

PROJECT: PULVERIZER		DESCRIPTION: TINE WELDMENT
SIZE	DWG. NO.	
A	100529	REV A
SCALE: NONE	WEIGHT: 8.02LBS	SHEET 1 OF 1

NOTES:

- MATERIAL:
ASTM A36 STEEL PIPE
NPS 2" SCH80

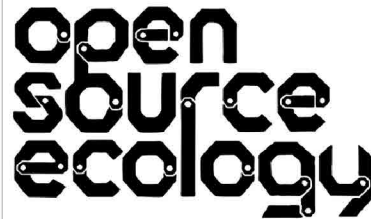
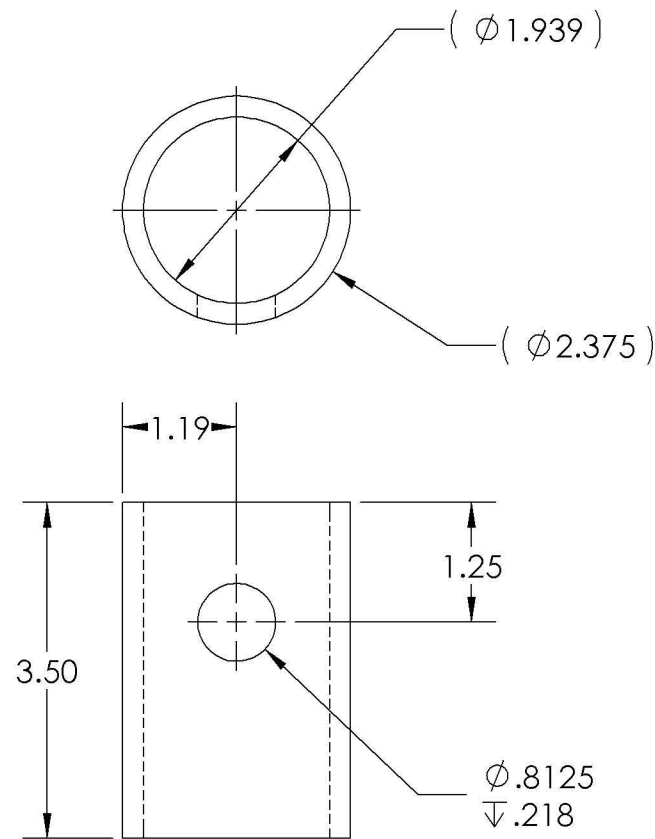

LICENSE INFORMATION
ALL INFORMATION IS RELEASED UNDER THE OSE LICENSE FOR DISTRIBUTIVE ECONOMICS. FOR FURTHER INFORMATION GO TO:
OPENSOURCEECOLOGY.ORG/WIKI/LICENSE

	NAME	DATE		
DRAWN	MA	2011-12-22		
CHECKED		YYYY/MM/DD		
APPR.		YYYY/MM/DD		
UNLESS OTHERWISE SPECIFIED DIMENSIONS ARE IN INCHES				
ANGLES	.X	.XX	.XXX	
	±.5	±.1	±.03	±.005



PROJECT: PULVERIZER	
DESCRIPTION: TUBE, TINE	
SIZE A	DWG. NO. 100530
SCALE: NONE	WEIGHT: 1.72LBS
SHEET 1 OF 1	
REV A	

NOTES:

1. MATERIAL:
ASTM A36 STEEL
2. MAKE APPROX 1" CUT IN MIDDLE OF FLAT
AND BEND EACH SIDE 45DEG

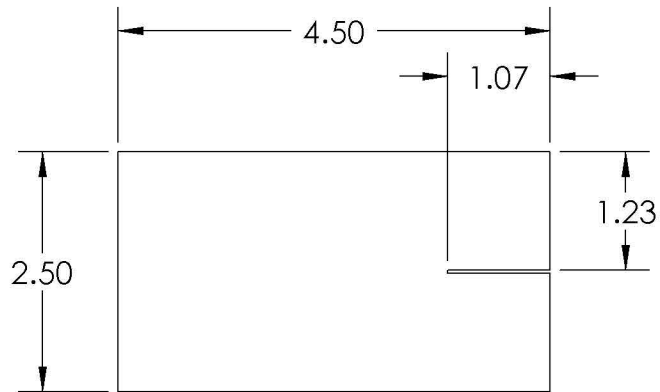

FLAT PATTERN

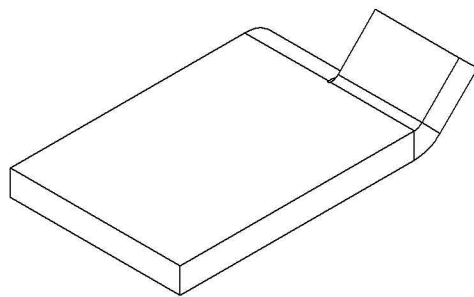
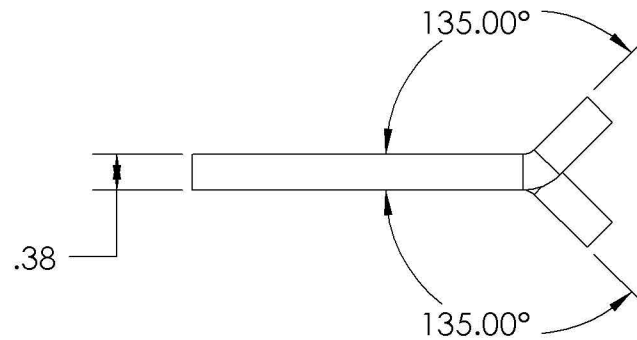
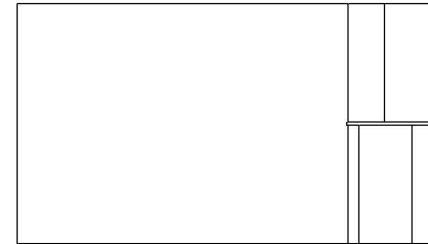

LICENSE INFORMATION
ALL INFORMATION IS RELEASED UNDER THE OSE
LICENSE FOR DISTRIBUTIVE ECONOMICS. FOR
FURTHER INFORMATION GO TO:
OPENSOURCEECOLOGY.ORG/WIKI/LICENSE

	NAME	DATE	PROJECT: PULVERIZER	
DRAWN	MA	2011-12-22	DESCRIPTION: TINE	
CHECKED		YYYY/MM/DD		
APPR.		YYYY/MM/DD		
UNLESS OTHERWISE SPECIFIED DIMENSIONS ARE IN INCHES				
ANGLES	.X	.XX	.XXX	
	±.5	±.1	±.03	±.005

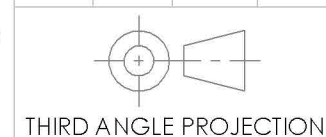

SIZE	DWG. NO.	REV
A	100531	A
SCALE: NONE	WEIGHT: 1.19LBS	SHEET 1 OF 1

NOTES:

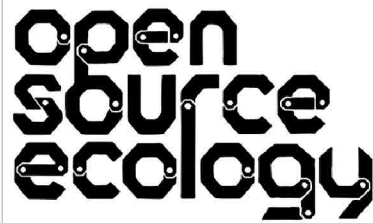
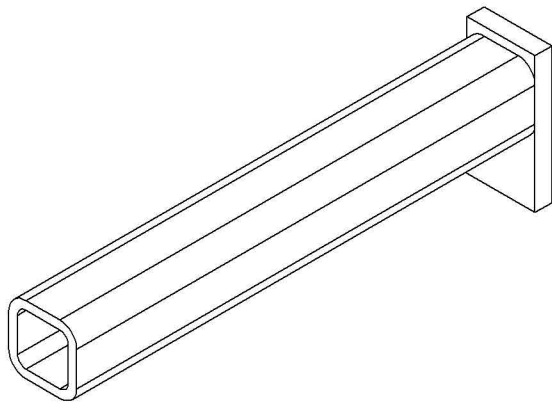
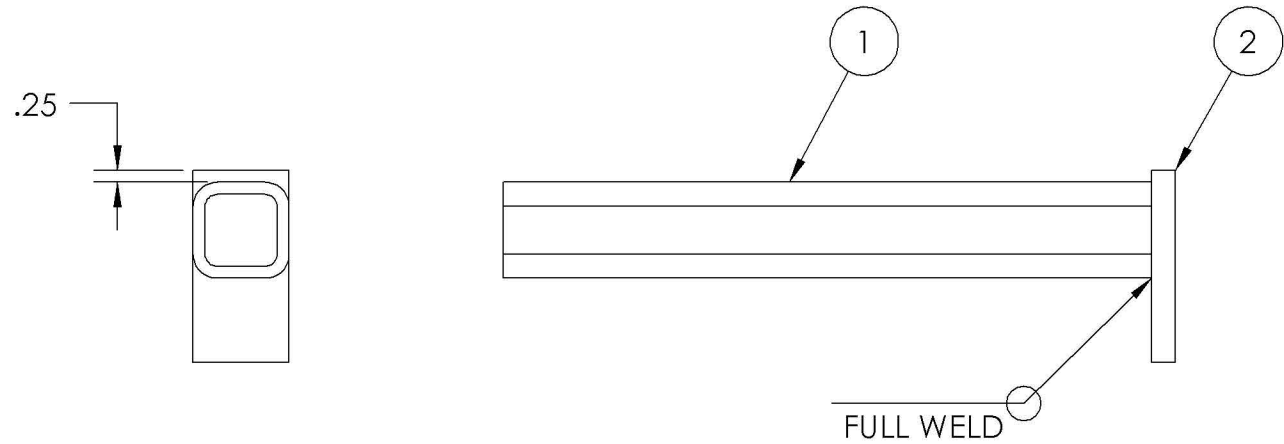

LICENSE INFORMATION
 ALL INFORMATION IS RELEASED UNDER THE OSE
 LICENSE FOR DISTRIBUTIVE ECONOMICS. FOR
 FURTHER INFORMATION GO TO:
 OPENSOURCEECOLOGY.ORG/WIKI/LICENSE

	NAME	DATE
DRAWN	MA	2011-12-22
CHECKED		YYYY/MM/DD
APPR.		YYYY/MM/DD
UNLESS OTHERWISE SPECIFIED DIMENSIONS ARE IN INCHES		
ANGLES	.X	.XX
	±.5	±.1
		±.03
		±.005

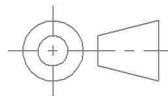

THIRD ANGLE PROJECTION

PROJECT: PULVERIZER	
DESCRIPTION: ARM REST WELDMENT	
SIZE A	DWG. NO. 100532
SCALE: NONE	WEIGHT: 7.22LBS
SHEET 1 OF 1	

REV
A

NOTES:

- MATERIAL:
ASTM A36 STEEL
SQUARE TUBING 2"X2" X 0.25"THICK

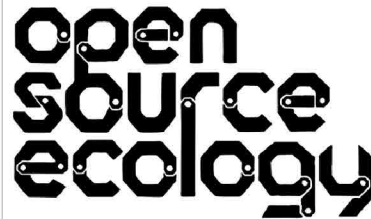
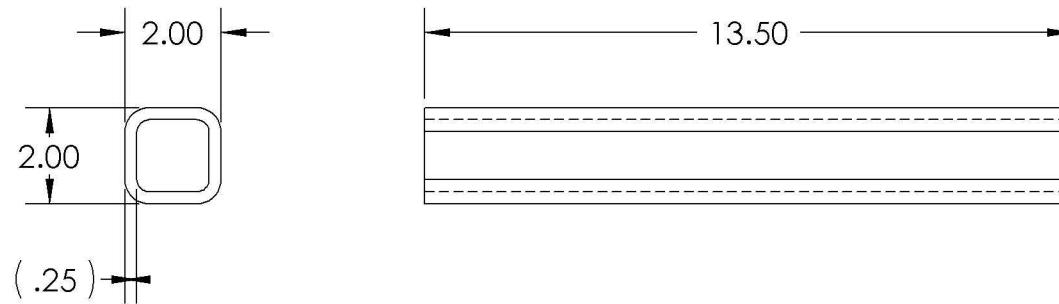

LICENSE INFORMATION
ALL INFORMATION IS RELEASED UNDER THE OSE
LICENSE FOR DISTRIBUTIVE ECONOMICS. FOR
FURTHER INFORMATION GO TO:
OPENSOURCEECOLOGY.ORG/WIKI/LICENSE

	NAME	DATE		
DRAWN	MA	2011-12-22		
CHECKED		YYYY/MM/DD		
APPR.		YYYY/MM/DD		
UNLESS OTHERWISE SPECIFIED DIMENSIONS ARE IN INCHES				
ANGLES	.X	.XX	.XXX	
	± .5	± .1	± .03	± .005

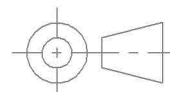

THIRD ANGLE PROJECTION

PROJECT:
PULVERIZER

DESCRIPTION:
SMALL TUBE, ARM

SIZE	DWG. NO.	REV
A	100533	A

SCALE: NONE	WEIGHT: 6.08LBS	SHEET 1 OF 1
-------------	-----------------	--------------

NOTES:

- MATERIAL:
ASTM A36 STEEL

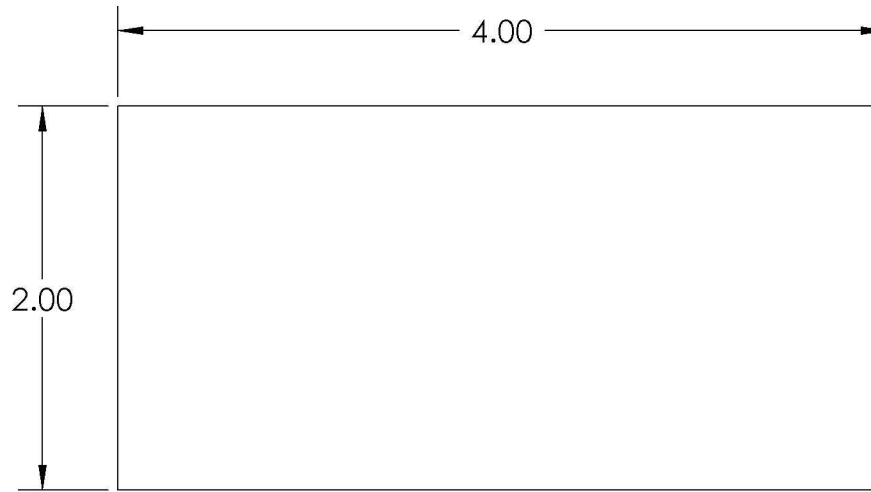

LICENSE INFORMATION
 ALL INFORMATION IS RELEASED UNDER THE OSE
 LICENSE FOR DISTRIBUTIVE ECONOMICS. FOR
 FURTHER INFORMATION GO TO:
OPENSOURCEECOLOGY.ORG/WIKI/LICENSE

	NAME	DATE		
DRAWN	MA	2011-12-22		
CHECKED		YYYY/MM/DD		
APPR.		YYYY/MM/DD		
UNLESS OTHERWISE SPECIFIED DIMENSIONS ARE IN INCHES				
ANGLES	.X	.XX	.XXX	
	± .5	± .1	± .03	± .005

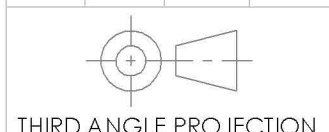

PROJECT:
PULVERIZER

DESCRIPTION:
PLATE, ARM REST

SIZE	DWG. NO.	REV
A	100534	A
SCALE: NONE	WEIGHT: 1.13LBS	SHEET 1 OF 1

NOTES:

- MATERIAL:
ASTM A36 STEEL

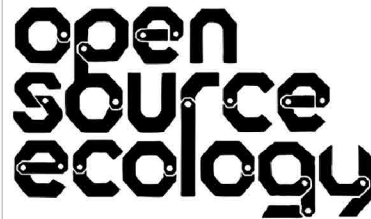
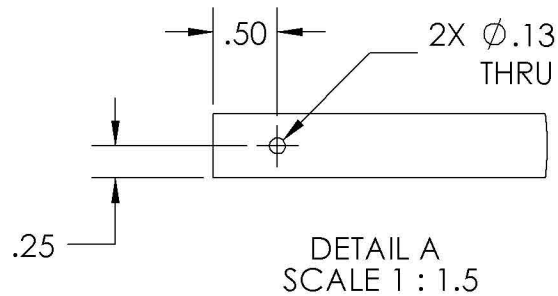
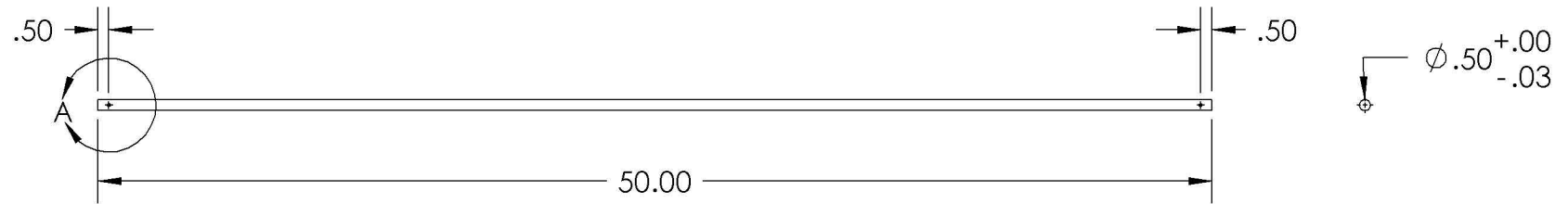

LICENSE INFORMATION
 ALL INFORMATION IS RELEASED UNDER THE OSE
 LICENSE FOR DISTRIBUTIVE ECONOMICS. FOR
 FURTHER INFORMATION GO TO:
OPENSOURCEECOLOGY.ORG/WIKI/LICENSE

	NAME	DATE		
DRAWN	MA	2011-12-22		
CHECKED		YYYY/MM/DD		
APPR.		YYYY/MM/DD		
UNLESS OTHERWISE SPECIFIED DIMENSIONS ARE IN INCHES				
ANGLES	.X	.XX	.XXX	
	± .5	± .1	± .03	± .005

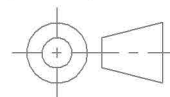

THIRD ANGLE PROJECTION

PROJECT: PULVERIZER	
DESCRIPTION: ROD, HINGE	
SIZE A	DWG. NO. 100538
SCALE: NONE	WEIGHT: 2.78LBS
REV A	SHEET 1 OF 1

NOTES:

- MATERIAL:
ASTM A36 STEEL

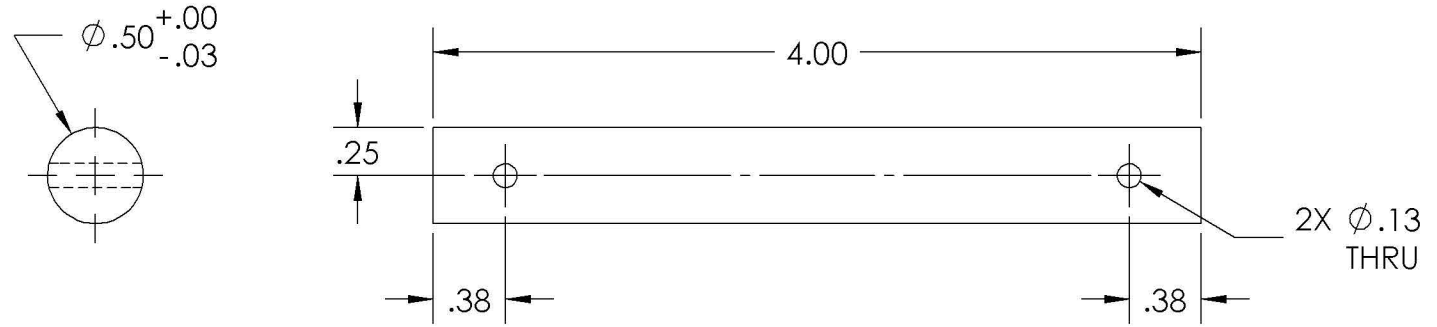

LICENSE INFORMATION
 ALL INFORMATION IS RELEASED UNDER THE OSE
 LICENSE FOR DISTRIBUTIVE ECONOMICS. FOR
 FURTHER INFORMATION GO TO:
OPENSOURCEECOLOGY.ORG/WIKI/LICENSE

	NAME	DATE		
DRAWN	MA	2011-12-22		
CHECKED		YYYY/MM/DD		
APPR.		YYYY/MM/DD		
UNLESS OTHERWISE SPECIFIED DIMENSIONS ARE IN INCHES				
ANGLES	.X	.XX	.XXX	
	± .5	± .1	± .03	± .005

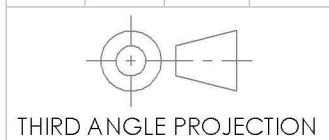

PROJECT:
PULVERIZER

DESCRIPTION:
ROD, PIN

SIZE	DWG. NO.	REV
A	100539	A

SCALE: NONE	WEIGHT: 0.22LBS	SHEET 1 OF 1
-------------	-----------------	--------------

NOTES:

1. MATERIAL:
ASTM A36 STEEL
2. ENSURE HINGE PIPE INNER DIAMETER ALLOWS $\phi 0.5"$
ROUNDSTOCK TO TRAVEL THROUGH IT

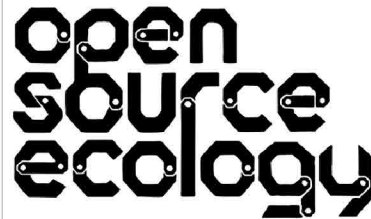
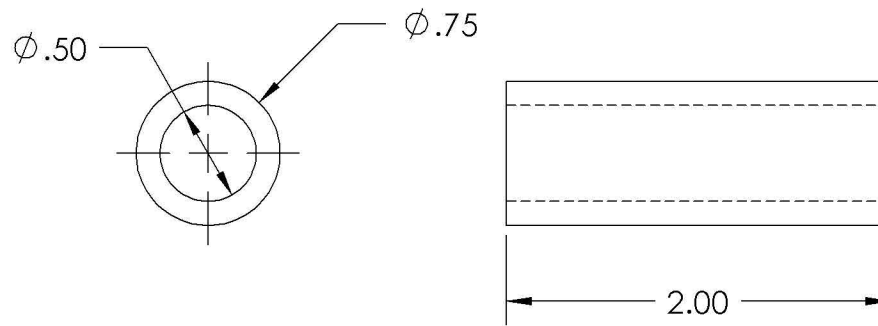

LICENSE INFORMATION
 ALL INFORMATION IS RELEASED UNDER THE OSE
 LICENSE FOR DISTRIBUTIVE ECONOMICS. FOR
 FURTHER INFORMATION GO TO:
OPENSOURCEECOLOGY.ORG/WIKI/LICENSE

	NAME	DATE
DRAWN	MA	2011-12-22
CHECKED		YYYY/MM/DD
APPR.		YYYY/MM/DD
UNLESS OTHERWISE SPECIFIED DIMENSIONS ARE IN INCHES		
ANGLES	.X	.XX
	$\pm .5$	$\pm .1$
		$\pm .03$
		$\pm .005$

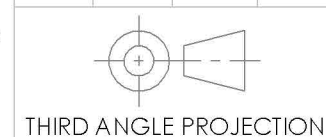

PROJECT: PULVERIZER		DESCRIPTION: HINGE PIPE
SIZE	DWG. NO.	
A	100540	REV A
SCALE: NONE	WEIGHT: 0.14LBS	SHEET 1 OF 1

NOTES:

1.MATERIAL:
 ASTM A36 HOT ROLLED STEEL
 1/8" THICK

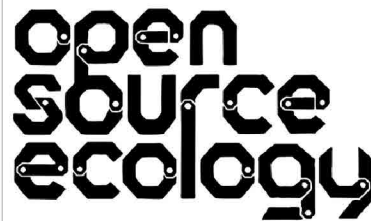
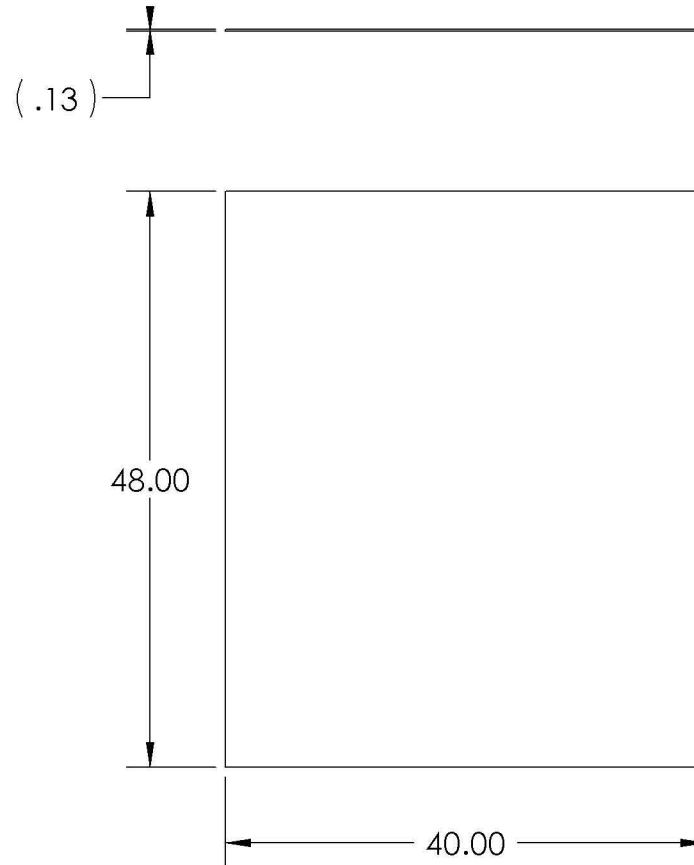

LICENSE INFORMATION
 ALL INFORMATION IS RELEASED UNDER THE OSE
 LICENSE FOR DISTRIBUTIVE ECONOMICS. FOR
 FURTHER INFORMATION GO TO:
OPENSOURCEECOLOGY.ORG/WIKI/LICENSE

	NAME	DATE		
DRAWN	MA	2011-12-22		
CHECKED		YYYY/MM/DD		
APPR.		YYYY/MM/DD		
UNLESS OTHERWISE SPECIFIED DIMENSIONS ARE IN INCHES				
ANGLES	.X	.XX	.XXX	
	± .5	± .1	± .03	± .005

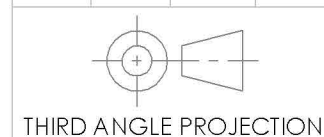

PROJECT:
PULVERIZER

DESCRIPTION:
TOP PLATE

SIZE	DWG. NO.	REV
A	100541	A
SCALE: NONE	WEIGHT: 68.1LBS	SHEET 1 OF 1

NOTES:

1. MATERIAL:
ASTM A36 STEEL
2. MAKE APPROX 1" CUT IN MIDDLE OF FLAT
AND BEND EACH SIDE 45DEG

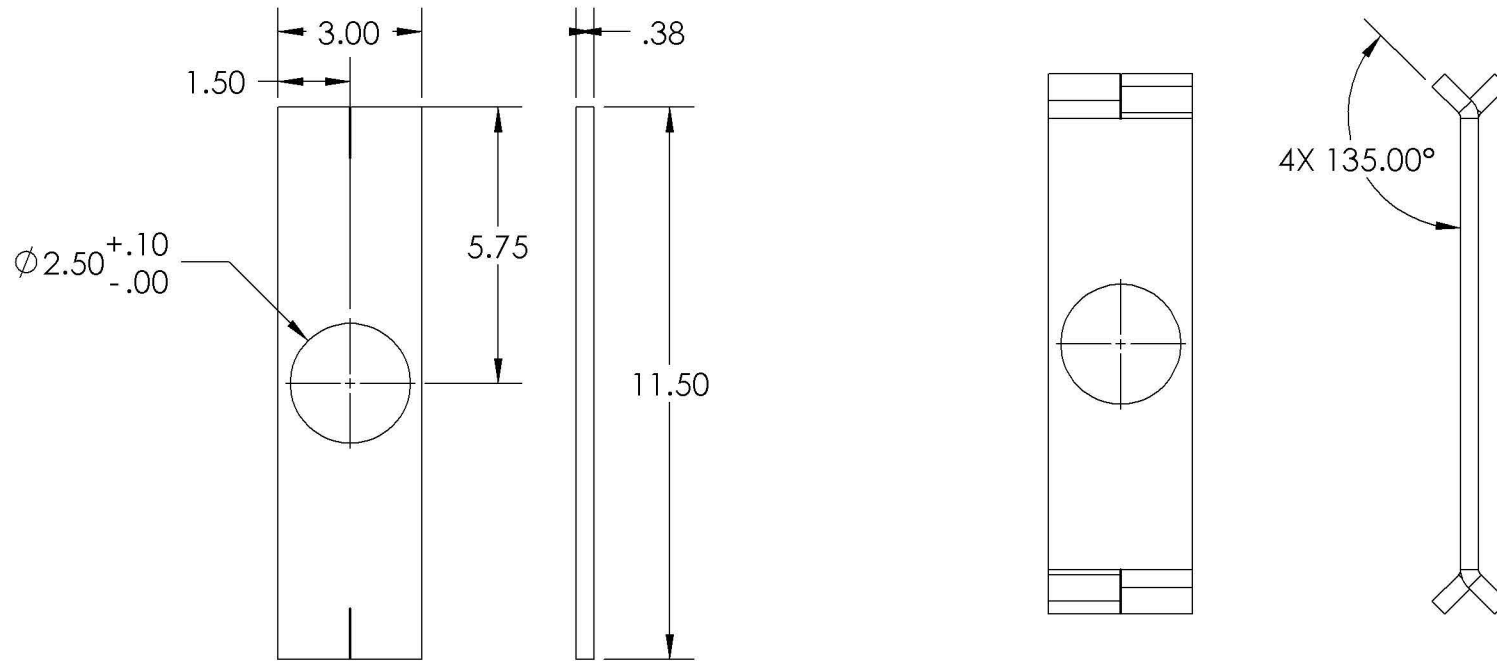

FLAT PATTERN

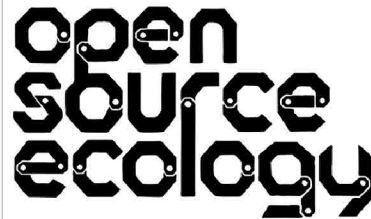
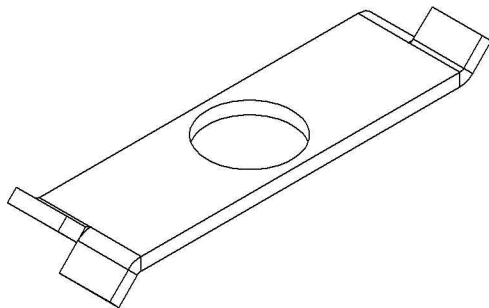

LICENSE INFORMATION
 ALL INFORMATION IS RELEASED UNDER THE OSE
 LICENSE FOR DISTRIBUTIVE ECONOMICS. FOR
 FURTHER INFORMATION GO TO:
OPENSOURCEECOLOGY.ORG/WIKI/LICENSE

	NAME	DATE
DRAWN	MA	2011-12-22
CHECKED		YYYY/MM/DD
APPR.		YYYY/MM/DD
UNLESS OTHERWISE SPECIFIED DIMENSIONS ARE IN INCHES		
ANGLES	.X	.XX
	±.5	±.1
		±.03
		±.005

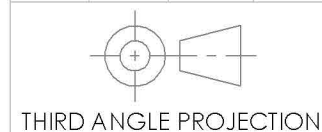

PROJECT: PULVERIZER	
DESCRIPTION: TINE	
SIZE A	DWG. NO. 100542
SCALE: NONE	WEIGHT: 3.14LBS
SHEET 1 OF 1	
REV A	

NOTES:

1. WELD FN 2 TO FN 3 FIRST. IF THERE IS ANY PLAY, CENTER FN 2 AS ACCURATELY AS POSSIBLE IN FN 3.
2. NEXT WELD FN 1 AND ENSURE PARTS ARE AS CONCENTRIC AS POSSIBLE BEFORE WELDING TOGETHER

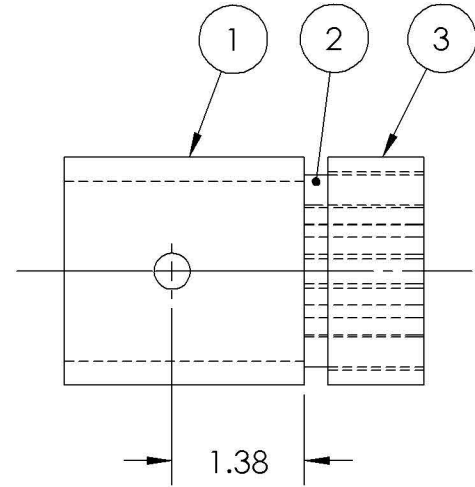
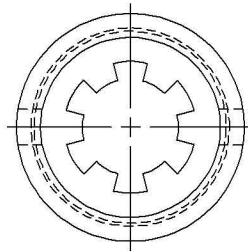
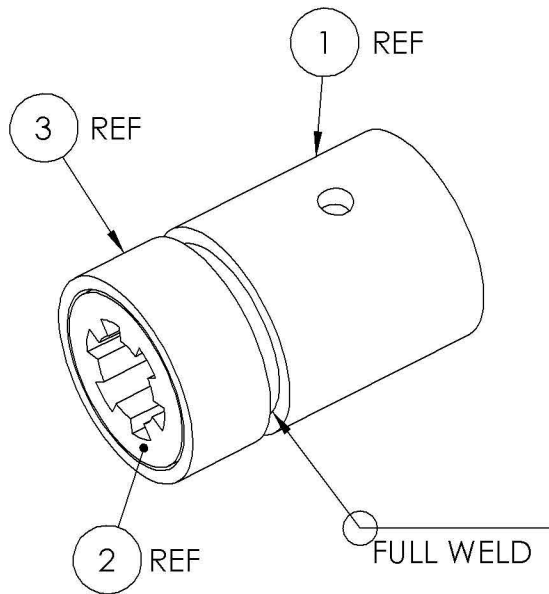

ITEM NO.	PART NUMBER	DESCRIPTION	QTY.
1	100545	COUPLER, SHAFT SIDE	1
2	100544	COUPLER, 1-3/8" 6T SPLINED MODIFIED	1
3	100546	PIPE, COUPLER MOTOR SIDE	1

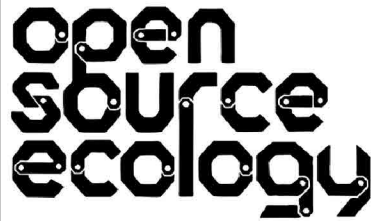

LICENSE INFORMATION
 ALL INFORMATION IS RELEASED UNDER THE OSE LICENSE FOR DISTRIBUTIVE ECONOMICS. FOR FURTHER INFORMATION GO TO:
OPENSOURCEECOLOGY.ORG/WIKI/LICENSE

	NAME	DATE	PROJECT:
DRAWN	MA	2011-12-22	PULVERIZER
CHECKED		YYYY/MM/DD	DESCRIPTION:
APPR.		YYYY/MM/DD	COUPLER, WELDMENT
UNLESS OTHERWISE SPECIFIED DIMENSIONS ARE IN INCHES			
ANGLES	.X	.XX	.XXX
	±.5	±.1	±.005

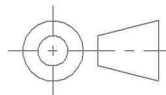

THIRD ANGLE PROJECTION

SIZE	DWG. NO.	REV
A	100543	A
SCALE: NONE	WEIGHT: 1.74LBS	SHEET 1 OF 1

NOTES:

1. MODIFIED VENDOR PART:

VENDOR: SURPLUS CENTER

PART NO: 167-02206

DESCRIPTION: 1-3/8" 6T SPLINED COUPLING 5"

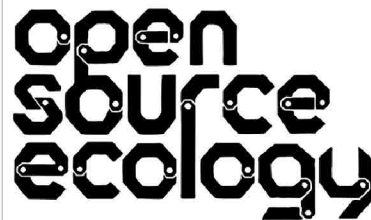
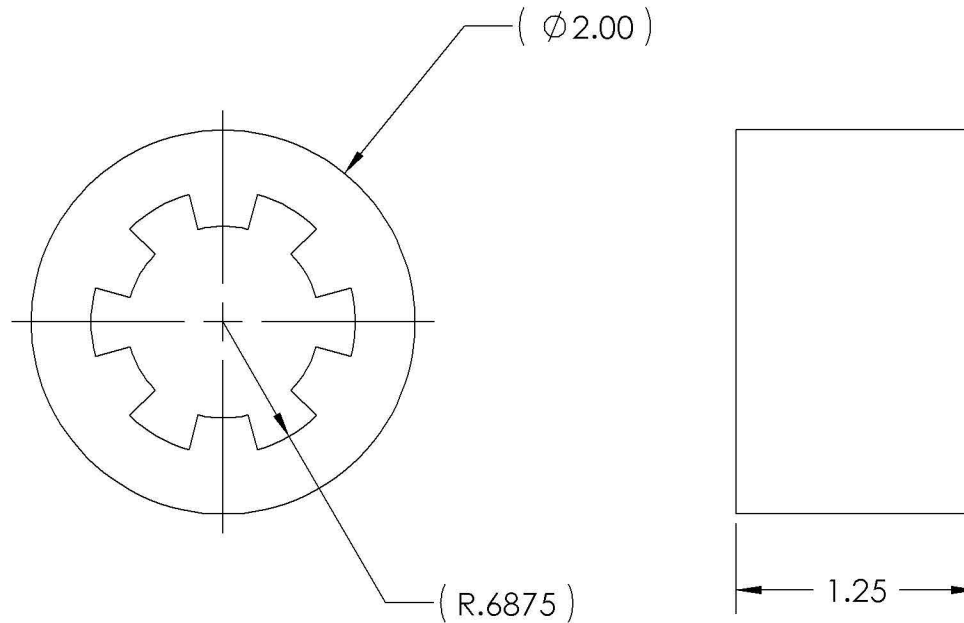

LICENSE INFORMATION
 ALL INFORMATION IS RELEASED UNDER THE OSE
 LICENSE FOR DISTRIBUTIVE ECONOMICS. FOR
 FURTHER INFORMATION GO TO:
OPENSOURCEECOLOGY.ORG/WIKI/LICENSE

	NAME	DATE
DRAWN	MA	2011-12-22
CHECKED		YYYY/MM/DD
APPR.		YYYY/MM/DD
UNLESS OTHERWISE SPECIFIED DIMENSIONS ARE IN INCHES		
ANGLES	.X	.XX
	±.5	±.1
		±.03
		±.005

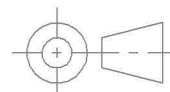

THIRD ANGLE PROJECTION

PROJECT: PULVERIZER	
DESCRIPTION: COUPLER, 1-3/8" 6T SPLINED MODIFIED	
SIZE A	DWG. NO. 100544
SCALE: NONE	WEIGHT: 0.71LBS
REV A	SHEET 1 OF 1

NOTES:

- MATERIAL:
ASTM A36 STEEL
PIPE ID 1-7/8" X OD 2-3/8" X 2.5"

2 THIS HOLE SHOULD BE DRILLED WITH SHAFT (PN 100528) PLACED INSIDE 2.125" FROM BOTTOM DIMENSIONED EDGE. THIS ENSURES HOLE ON THIS PART AND HOLE ON SHAFT LINE UP, ALLOWING BOLT TO PASS THROUGH THEM.

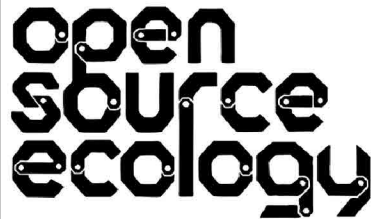
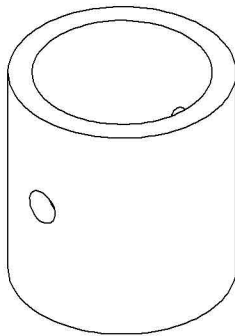
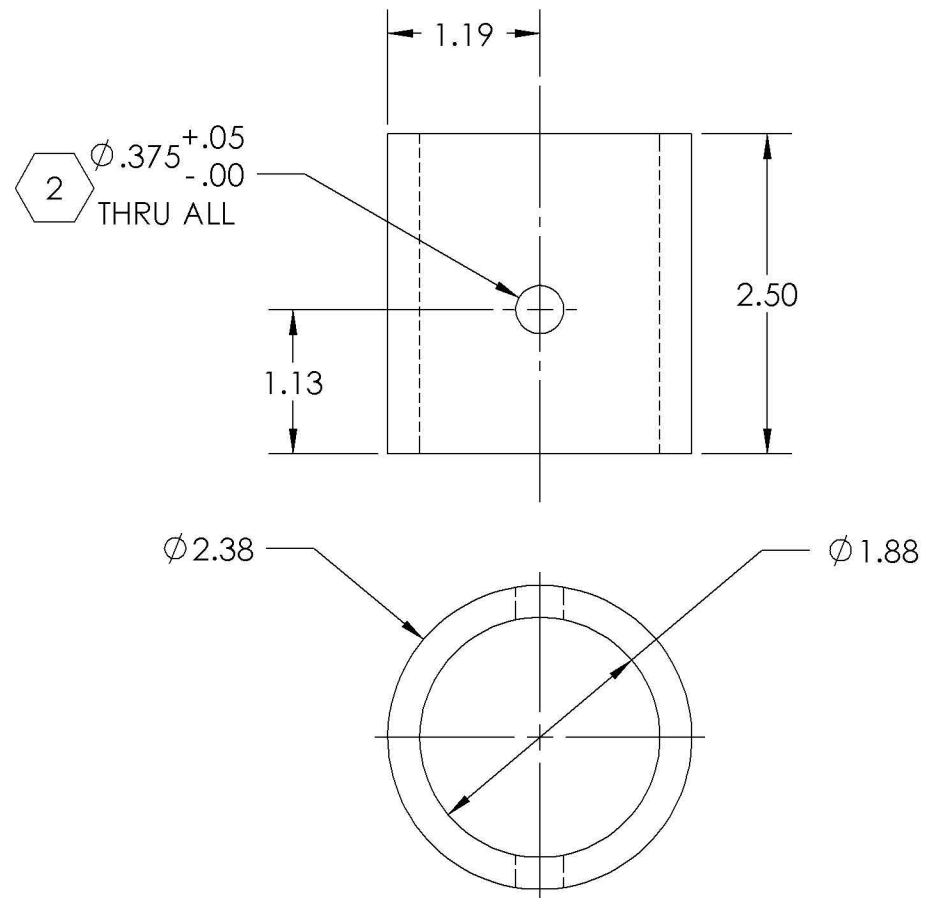

LICENSE INFORMATION
ALL INFORMATION IS RELEASED UNDER THE OSE LICENSE FOR DISTRIBUTIVE ECONOMICS. FOR FURTHER INFORMATION GO TO:
OPENSOURCEECOLOGY.ORG/WIKI/LICENSE

	NAME	DATE
DRAWN	MA	2011-12-22
CHECKED		YYYY/MM/DD
APPR.		YYYY/MM/DD
UNLESS OTHERWISE SPECIFIED DIMENSIONS ARE IN INCHES		
ANGLES	.X	.XX
±.5	±.1	±.03
	.XXX	±.005

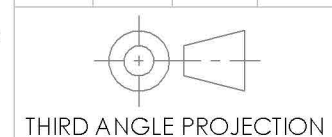

PROJECT: PULVERIZER	
DESCRIPTION: COUPLER, SHAFT SIDE	
SIZE A	DWG. NO. 100545
SCALE: NONE	WEIGHT: 1.03LBS
SHEET 1 OF 1	

REV
A

NOTE:

- MATERIAL:
ASTM A36 STEEL
2" SCH40 PIPE

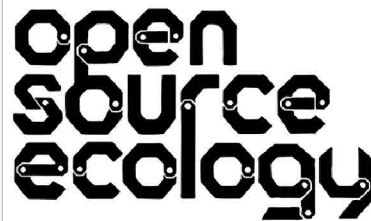
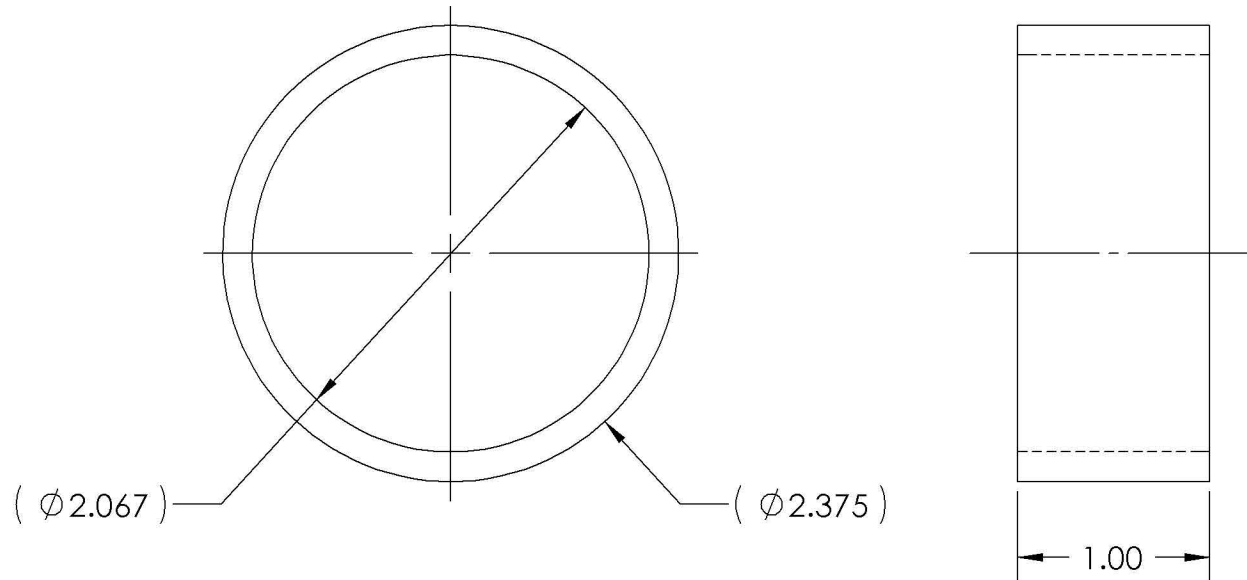

LICENSE INFORMATION
ALL INFORMATION IS RELEASED UNDER THE OSE
LICENSE FOR DISTRIBUTIVE ECONOMICS. FOR
FURTHER INFORMATION GO TO:
OPENSOURCEECOLOGY.ORG/WIKI/LICENSE

	NAME	DATE		
DRAWN	MA	2011-12-30		
CHECKED		YYYY/MM/DD		
APPR.		YYYY/MM/DD		
UNLESS OTHERWISE SPECIFIED DIMENSIONS ARE IN INCHES				
ANGLES	.X	.XX	.XXX	
	±.5	±.1	±.03	±.005

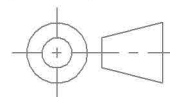

THIRD ANGLE PROJECTION

PROJECT:
PULVERIZER

DESCRIPTION:
**PIPE, COUPLER
MOTOR SIDE**

SIZE	DWG. NO.	REV
A	100546	A

SCALE: NONE	WEIGHT: 0.30LBS	SHEET 1 OF 1
-------------	-----------------	--------------